



Table of Contents

Highlights of 2025-2026	4
Faculties and Programs	7
Undergraduate Programs	7
Graduate Programs	8
Student Data 2025-2026	9
Undergraduate and Graduate Students by Faculty, Gender, and Full-time (FT)/Part-time (PT) Status, 2025-2026	9
Undergraduate Students and Fiscal Full-time Equivalents (FFTEs) by Faculty, Program and Full-Time (FT)/Part-Time (PT) Status, 2025-2026...	11
Graduate Students and Full-time Equivalents (FTEs) by Faculty, Program, Degree and Full-time (FT)/Part-time (PT) Status, 2025-2026.....	16
Undergraduate Student Headcount by Year of Study, 2025-2026	18
Students	20
Undergraduate Student Demographics.....	21
Graduate Student Demographics.....	22
Undergraduate Student Count by Faculty	23
Graduate Student Count by Faculty	24
Undergraduate FFTEs by Faculty.....	25
Graduate FTEs by Faculty.....	25
Age Distribution of Students	26
New Student Admission Averages.....	27
New Student Applications from Ontario High Schools and Yield Rates	28
Distribution of First-year Class Sizes	29
Distribution of Fourth-year Class Sizes	30
Degrees/Diplomas Granted.....	31
Total Degrees/Diplomas Conferred by Faculty	33
Faculty and Staff	34
Continuing Staff, 2025-2026	34
Tenure and Tenure-Track Faculty.....	35
Tuition and Fees	37
Undergraduate Tuition and Fees (2025-2026 full-time fee schedule)	37
Graduate – Program Based Tuition and Fees (2025-2026 full-time fee schedule)	38
Graduate - Credit Based Tuition and Fees	38
Ancillary Fees.....	39
Student Financial Aid and Scholarships	42
Student Scholarships and Awards, 2025-2026	42
Student Financial Aid, 2025-2026.....	44
Research	45
Research Grants and Contracts by Faculty and by Source, 2025-2026.....	45
Percentage of Total Research Grants Held by Faculty, 2025-2026.....	46
Research Grants and Contracts from Tri-Council by Faculty/School, 2025-2026.....	46
Research Intensity Per Capita	49

Finance	50
Library	51
Number of Library Holdings	51
Library Personnel.....	52
Residences	53
Residence Accommodation Located on Ontario Tech University/Durham College Property.....	53
Athletics	54
Student Athletes by Sport, 2025-2026.....	54
Fact Book Glossary	55
Contact	57

Highlights of 2025-2026

Leadership

- Ontario Tech University was ranked No. 1 in Canada for [Research University of the Year](#) (Undergraduate category) for the third consecutive year by Research Infosource, highlighting its national leadership in research output, intensity and impact.
- Ontario Tech University has been named [Most Sustainably Improved University](#) in the 2025 UI GreenMetric World University Rankings, which assess institutions worldwide on environmental performance, infrastructure and sustainability initiatives.
- Ontario Tech University set a new enrolment record for the 2025–2026 academic year, with more than 2,200 Ontario high school students confirming their admission offers—a [9.3 per cent increase over the previous year and above the provincial average](#). The continued growth reflects strong demand for the university’s future-ready programs, career-connected learning opportunities, and student-centred educational experience.
- Ontario Tech President [Dr. Steven Murphy](#) outlined in a new op-ed published in the National Post how Canada can become a global leader in responsible AI by championing a human-centred approach that balances innovation with ethics, privacy and public trust.
- Ontario Tech University announced the appointment of [Dr. Pejman Mirza-Babaei](#) as the new Dean of the School of Graduate and Postdoctoral Studies (SGPS), effective Tuesday, July 1, 2025.
- Ontario Tech University launched the [Indigenous and Black Engineering and Technology \(IBET\) PhD Momentum Fellowship](#), providing significant funding, mentorship and academic support to increase representation in engineering research and academia.
- Ontario Tech University paid tribute to [Elder Shirley Williams \(Migizi-ow-kwe\)](#), an esteemed Anishinaabemowin teacher, language advocate and community leader whose work advanced Indigenous language revitalization, reconciliation and education. As an honorary Doctor of Laws recipient and member of the university’s President’s Reconciliation Task Force, her wisdom and guidance left a lasting impact on Ontario Tech’s commitment to truth, learning and reconciliation.

Investigating and Partnering Around the Ethical Applications of Technology

- Ontario Tech University has made history with the launch of [Canada’s first School of Artificial Intelligence \(SAI\)](#): a groundbreaking step that emphasizes AI governance while embracing the fourth industrial revolution. This transformative initiative underscores Ontario Tech’s commitment to tech with a conscience, ensuring innovation serves humanity and the planet.
- Ontario Tech University received a high-fidelity simulation mannequin donation from [Laerdal Medical Canada](#) to enhance experiential learning and prepare students for emerging careers in health-care simulation and education. The partnership will provide hands-on training, technical workshops and industry exposure, helping students build practical skills for Canada’s evolving health-care workforce.
- Dr. Mariana Shimabukuro, a researcher at Ontario Tech University has developed an educational online tool – [LangEye](#) that uses advanced technology to make the learning journey fast, effective, and even fun. It helps people learn new words in a foreign language by connecting them with real-life objects.
- Dr. Jennifer Abbass Dick, Associate Professor in the university’s Faculty of Health Sciences, has partnered with Lakeridge Health and the Durham Region Health Department to launch [AboutBreastfeeding.ca](#), a national e-health platform designed to boost breastfeeding health literacy.

Student Success and initiative

- [Jessica M. Biasin](#) a Master of Science (Forensic Psychology) student in Ontario Tech University's Faculty of Social Science and Humanities, earned first place at Ontario Tech's annual Three Minute Thesis (3MT®) competition with her research presentation titled "Developmental Patterns of Honesty from Childhood to Adolescence: A Six-Year Longitudinal Investigation".
- Competing in the USF Pro 2000 Championship junior IndyCar racing series, Ontario Tech University Automotive Engineering student [Mac Clark](#) secured multiple podium finishes during the 2025 season, including a third-place result at Toronto's Race One in July.
- Ontario Tech University celebrates four Faculty of Engineering and Applied Science students who have earned Hydro One awards. This year, three third-year Software Engineering students – [Inshal Chauhdry, Caren Eissa and Aliza Rizwan](#) are among nine recipients of the Hydro One Women in Engineering Award along with [Oladipupo Aganga](#), a second-year Electrical Engineering student who was one of five recipients of the Hydro One William Peyton Hubbard Memorial Award.

Building partnerships and community connections

- Ontario Tech University's Faculty of Engineering and Applied Science has signed a Memorandum of Understanding (MOU) with global mobility leader [Hitachi Rail](#) to support a first-of-its-kind in Canada, Railway Engineering specialization program. Signed by Dr. Hossam Kishawy, Dean, Faculty of Engineering and Applied Science and Ziad Rizk, Managing Director, Hitachi Rail Canada, the MOU will help address the growing demand for skilled professionals in Canada's rail sector and strengthen collaboration between the rail industry and the next generation of Canadian engineers.
- With demand for nuclear talent on the rise, [Saskatchewan Polytechnic](#) and Ontario Tech University have partnered to deliver the Nuclear Career Accelerator program in Western Canada. Under the agreement, Saskatchewan Polytechnic will be the exclusive delivery partner for the program across British Columbia, Alberta, Saskatchewan and Manitoba. The program provides foundational training in nuclear systems, safety and regulatory frameworks and is structured to support working professionals through applied, industry-aligned learning.
- Ontario Tech University has launched [EDGE](#), a private training company powered by the university that delivers executive learning and rapid skills development for organizations navigating technological change and evolving labour market demands.
- [Indigenous Education and Cultural Services \(IECS\)](#)—in partnership with the Faculty of Social Sciences and Humanities, the City of Oshawa, Region of Durham, Pickering Public Library, City of Pickering – Indigenous Relationship Building Circle, and EarlyON Child and Family Centre—hosted Ontario Tech's first Round Dance at Charles Hall. The Round Dance brought community members together in ceremony, reflection and celebration.
- Students interested in pursuing a legal career now have a way of achieving their goal sooner, thanks to a new accelerated program at Ontario Tech University. Offered in partnership with [Teesside University](#) in the U.K., the unique Legal Studies (BA) and Law (U.K. LLB) - Accelerated Law pathway combines legal training in Canada and the U.K, this direct-entry option [offers the fastest route to a law degree in Canada](#), enabling students to earn two degrees in five years of full-time study: a Bachelor of Arts (Honours) in Legal Studies from Ontario Tech, and Bachelor of Laws (LLB) from Teesside (equivalent to a Juris Doctor degree in Canada).

Learning re-imagined

- Ontario Tech University launched Canada’s first [Master of Social Media Communication in Online Creators](#), a graduate program designed to prepare content creators, digital strategists and social media professionals for leadership in the rapidly growing creator economy. The program combines digital storytelling, analytics, AI tools, monetization and ethical leadership with hands-on capstone projects that address real-world industry challenges.
- Ontario Tech University launched a human-centred [AI Learning Agent](#) pilot across 22 undergraduate and graduate courses to help students use AI responsibly while strengthening critical thinking and academic integrity. Designed within a secure, privacy-protected environment, the system uses instructor-approved materials and gives students hands-on experience in ethical AI governance and development.

Research and development

- The Government of Canada invested \$5 million in Ontario Tech University’s [Automotive Centre of Excellence \(ACE\)](#) to expand its capabilities as a leading Canadian defence technology hub. The investment will support research, testing and commercialization of advanced vehicles, aerospace systems, drones and emerging defence technologies, helping strengthen Canada’s defence innovation capacity, supply chains and high-skilled workforce development.
- The [Canadian Chiropractic Association \(CCA\)](#), in partnership with Ontario Tech University, has established a new Senior Scientist in Knowledge Translation & Health Policy position for the 2026–2029 term. Carol Cancelliere, DC, MPH, MBA, PhD, serves in this role, bringing expertise in clinical epidemiology, evidence-based practice in musculoskeletal health and rehabilitation, implementation research, digital health-enabled service design, and health policy and decision-making.
- Ontario Tech researcher [Dr. Nick La Delfa](#) is leading innovative virtual reality ergonomics research in partnership with General Motors to help design safer and more efficient manufacturing workplaces. His work uses immersive technology and human-movement analysis to reduce injuries, improve worker well-being and support the future of advanced automotive production.
- Ontario Tech University launched the [Mindful Artificial Intelligence Research Institute \(MAIRI\)](#), a new interdisciplinary hub advancing ethical, people-first AI innovation focused on fairness, inclusivity and sustainability. Bringing together more than 50 researchers and partners across academia, industry and community organizations, MAIRI strengthens Canada’s leadership in responsible AI research and governance.
- Ontario Tech University has received a transformational \$1 million gift from the [Sienna for Seniors Foundation](#), the charitable arm of Sienna Senior Living, to establish the Sienna Senior Living Research Centre for Healthy Aging and Happiness. The investment will help support applied, human-centred research focused on improving happiness and quality of life for older adults and the people who care for them.

Faculties and Programs

Faculties

- **Faculty of Business and Information Technology**
- **Frazer Faculty of Education**
- **Faculty of Engineering and Applied Science**
- **Faculty of Health Sciences**
- **Faculty of Science**
- **Faculty of Social Science and Humanities**

Undergraduate Programs

(B) Bridge and/or Advanced Entry option

(C) Co-op option

- **Undergraduate Diploma**
 - Designing Adult Learning for the Digital Age
 - Public Policy
- **Bachelor of Allied Health Sciences (B)**
- **Pre-Engineering**
- **Bachelor of Arts:**
 - Communication and Digital Media Studies (B)
 - Criminology and Justice (B)
 - Educational Studies (B)
 - Forensic Psychology (B)
 - Legal Studies (B)
 - Liberal Studies (B)
 - Political Science (B)
 - Psychology (B)
- **Bachelor of Commerce:**
 - Accounting (B) (C)
 - Commerce (B) (C)
 - Entrepreneurship (B) (C)
 - Finance (B) (C)
 - Marketing (B) (C)
 - Organizational Behaviour and Human Resources Management (B) (C)
 - Technology Management (B) (C)
- **Bachelor of Education:**
 - Intermediate/Senior
 - Primary/Junior
- **Bachelor of Engineering:**
 - Automotive Engineering (C)
 - Electrical Engineering (C)
 - Energy Engineering (C)
 - Industrial Engineering (C)
 - Manufacturing Engineering (C)
 - Mechanical Engineering (C)
 - Mechatronics Engineering (C)
 - Nuclear Engineering (C)
 - Software Engineering (C)
- **Bachelor of Engineering and Management:**
 - Automotive Engineering (C)
 - Electrical Engineering (C)
 - Energy Engineering (C)
 - Industrial Engineering (C)
 - Manufacturing Engineering (C)
 - Mechanical Engineering (C)
 - Mechatronics Engineering (C)
 - Nuclear Engineering (C)
 - Software Engineering (C)
- **Bachelor of Health Administration**
- **Bachelor of Health Science:**
 - Comprehensive
 - Kinesiology (B)
 - Medical Laboratory Science (B)
- **Bachelor of Information Technology:**
 - Game Development and Interactive Media (B)
 - Networking and Information Technology (IT) Security (B)
 - Technology Management (B)
- **Bachelor of Science:**
 - Applied and Industrial Math (C)
 - Biological Science (B) (C)
 - Chemistry (C)
 - Computer Science (B) (C)
 - Forensic Science
 - Health Physics and Radiation Science
 - Integrated Mathematics and Computer Science (C)
 - Neuroscience (C)
 - Mathematics for Science and Industry (C)
 - Physics (C)
 - Psychology
- **Bachelor of Science and Management:**
 - Biological Science (C)
 - Chemistry (C)
 - Computer Science (C)
 - Forensic Science
 - Integrated Mathematics and Computer Science (C)
 - Neuroscience (C)
 - Mathematics for Science and Industry (C)
 - Physics (C)
- **Bachelor of Science in Nursing (B)**

Graduate Programs

- **Graduate Diploma**
 - Accounting
 - Education in the Digital Age
 - Engineering Management
 - Nuclear Design Engineering
 - Nuclear Engineering - UNENE
 - Nuclear Technology
 - Fuel, Materials and Chemistry
 - Health Physics
 - Operation and Maintenance
 - Radiological Applications
 - Reactor Systems
 - Safety, Licensing and Regulatory Affairs
 - Police Leadership
 - Work Disability Prevention
- **MA – Master of Arts**
 - Criminology
 - Education
 - Social Practice and Innovation
- **MASc – Master of Applied Science**
 - Automotive Engineering
 - Electrical and Computer Engineering
 - Mechanical Engineering
 - Mechatronics Engineering
 - Nuclear Engineering
 - Software Engineering
- **MBAI – Master of Business Analytics and Artificial Intelligence**
- **MITS – Master of Information Technology Security**
- **MEd – Master of Education**
- **MEng – Master of Engineering**
 - Automotive Engineering
 - Electrical and Computer Engineering
 - Mechanical Engineering
 - Mechatronics Engineering
 - Nuclear Engineering
 - Nuclear Engineering – UNENE
 - Software Engineering
- **MEngM – Master of Engineering Management**
- **MFDA – Master of Financial Data Analytics**
- **MHSc – Master of Health Sciences**
- **MSc – Master of Science**
 - Applied Bioscience
 - Computer Science
 - Forensic Psychology
 - Materials Science
 - Modelling and Computational Science
- **MScN – Master of Science in Nursing**
- **EdD – Doctor of Education**
- **PhD – Doctor of Philosophy**
 - Applied Bioscience
 - Computer Science
 - Criminology and Social Justice
 - Electrical and Computer Engineering
 - Forensic Psychology
 - Health Sciences
 - Materials Science
 - Mechanical Engineering
 - Modelling and Computational Science
 - Nuclear Engineering
 - Cybersecurity



Student Data 2025-2026

All data summarizes official student enrolment as reported by Ontario Tech University to the Ministry of Colleges and Universities. Unless otherwise indicated, all enrolments are as of November 1, 2025. Students pursuing more than one degree are counted within their major field of study. The methodology used in calculating all counts is considered true as of the date of publication. During 2022-2023, in order to better align disciplines and combine expertise, the Faculty of Energy Systems and Nuclear Science was integrated into the Faculty of Engineering and Applied Science as a department. Faculty-level data provided from 2023-2024 and beyond reflects this change.

Undergraduate and Graduate Students by Faculty, Gender, and Full-time (FT)/Part-time (PT) Status, 2025-2026

Faculty	Undergraduate					Graduate					FT Total	PT Total	All	
	Full-time Total	%F	Part-time Total	%F	Total	Full-time Total	%F	Part-time Total	%F	Total			Total	%F
Faculty of Business & Information Technology	2322	25.1%	221	24.9%	2543	307	36.5%	24	33.3%	331	2,629	245	2,874	26.3%
Frazer Faculty of Education	1344	77.5%	125	84.0%	1469	202	75.3%	112	75.9%	314	1,546	237	1,783	77.6%
Faculty of Engineering & Applied Science	2751	14.3%	159	12.6%	2910	390	29.5%	58	27.6%	448	3,141	217	3,358	16.2%
Faculty of Health Sciences	2283	74.0%	154	66.2%	2437	65	69.2%	34	79.4%	99	2,348	188	2,536	73.5%
Faculty of Science	1757	35.4%	79	27.9%	1836	115	47.8%	10	30.0%	125	1,872	89	1,961	35.8%
Faculty of Social Science and Humanities	1185	66.3%	65	64.6%	1250	71	80.3%	4	75.0%	75	1,256	69	1,325	67.0%
Undeclared	13	46.2%	4	75.0%	17	1	0.0%			1	14	4	18	50.0%
Grand Total	11,655	44.0%	807	43.3%	12,462	1,151	46.6%	242	58.7%	1,393	12,806	1,049	13,855	44.4%

Note: totals include male, female, and undisclosed gender

Undergraduate and Graduate Students by Faculty, Gender, and Full-time(FT)/Part-time(PT) Status, 2025-2026 (n=13,855)

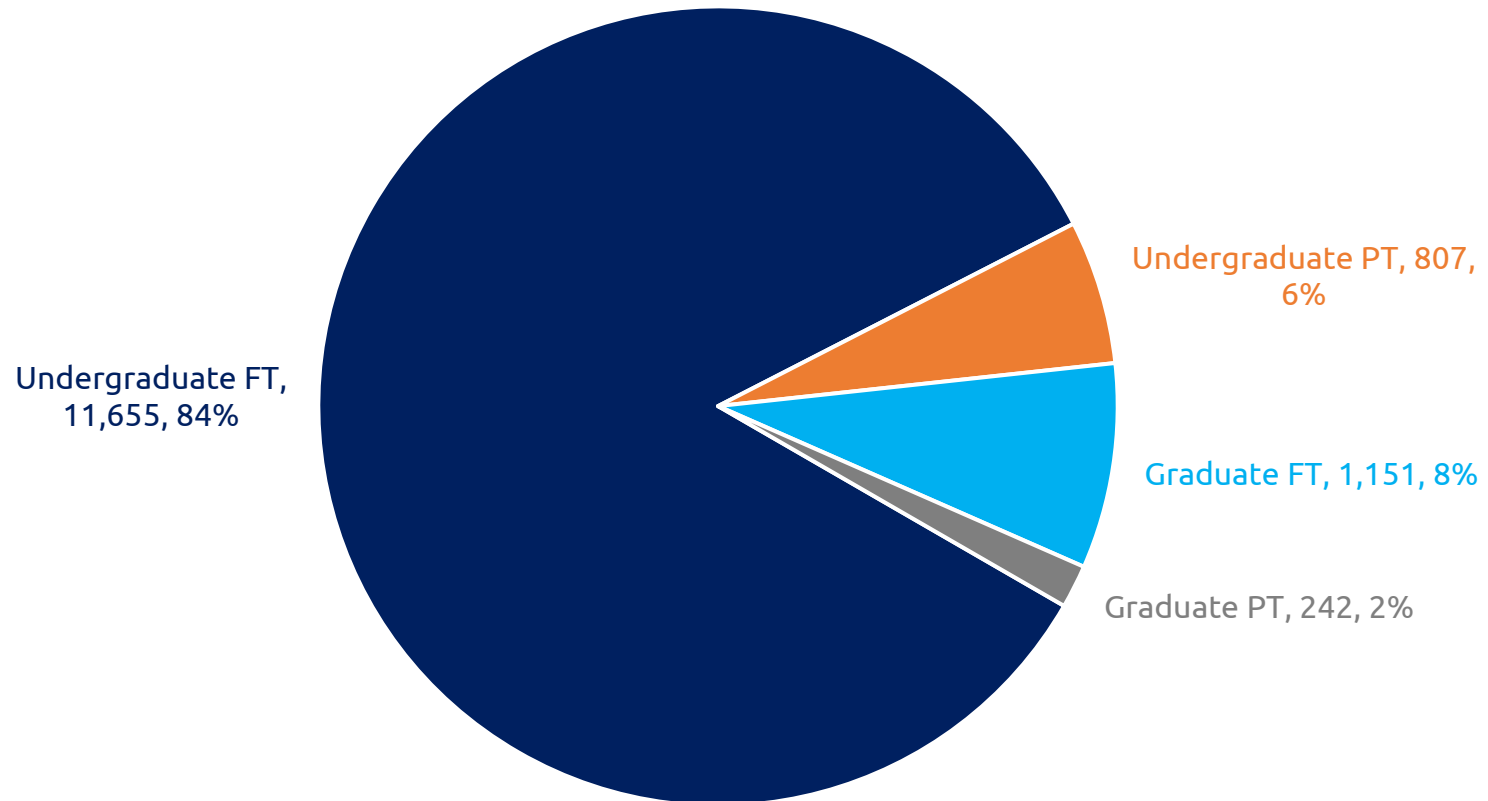

Undergraduate Students and Fiscal Full-time Equivalents (FTEs) by Faculty, Program and Full-Time (FT)/Part-Time (PT) Status, 2025-2026

Faculty	Program	FT	PT	Total	FTEs
Faculty of Business and Information Technology	Accounting	226	16	242	227.2
	Accounting (Co-op)	130	1	131	120.0
	Business	149	11	160	152.4
	Business (Co-op)	59	1	60	53.8
	Business Bridging Program	48	6	54	37.0
	Embedded Program - BComm		89	89	43.1
	Embedded Program - BIT		25	25	12.6
	Entrepreneurship	19		19	15.4
	Entrepreneurship (Co-op)	12	1	13	12.0
	Finance	240	14	254	241.2
	Finance (Co-op)	61	2	63	62.2
	Game Development and Entrepreneurship	1		1	0.5
	Game Development and Interactive Media	284	8	292	272.5
	Marketing	111	9	120	112.4
	Marketing (Co-op)	41		41	35.9
	Marketing (Post Bridge)	1		1	1.4
	Networking and IT Security	487	20	507	456.1
	Organizational Behaviour & HR Management	66	5	71	69.0
	Organizational Behaviour & HR Management (Co-op)	12		12	10.7
	Technology Management – BIT	140	8	148	139.0
	Technology Management – BCOMM	160	5	165	158.1
	Technology Management – BCOMM (Co-op)	75		75	67.6
	Business and Information Technology Total	2,322	221	2,543	2300.4
Frazer Faculty of Education	Educational Studies and Digital Technology		2	2	0.7
	Educational Studies	762	121	883	884.6
	Education (Consecutive) - Intermediate/Senior	237	2	239	235.9
	Education (Consecutive) - Primary/Junior	345		345	343.7
	Education Total	1,344	125	1,469	1464.9

Undergraduate Students and Fiscal Full-time Equivalents (FTEs) by Faculty, Program and Full-Time (FT)/Part-Time (PT) Status, 2025-2026 (Continued)

Faculty	Program	FT	PT	Total	FTEs
Faculty of Engineering and Applied Science	Automotive Engineering	49	7	56	41.3
	Automotive Engineering (Co-op)	155	7	162	141.2
	Comprehensive	35		35	44.4
	Electrical Engineering	79	9	88	70.5
	Electrical Engineering (Co-op)	255	8	263	220.6
	Energy Engineering	9		9	7.5
	Energy Engineering (Co-op)	45	2	47	40.5
	Health Physics and Radiation Science	3		3	3.0
	Industrial Engineering	12		12	12.8
	Industrial Engineering (Co-op)	24		24	20.2
	Manufacturing Engineering	8		8	6.7
	Manufacturing Engineering (Co-op)	14	1	15	12.2
	Mechanical Engineering	132	11	143	117.1
	Mechanical Engineering (Co-op)	524	15	539	471.3
	Mechatronics Engineering	92	15	107	77.2
	Mechatronics Engineering (Co-op)	481	7	488	416.1
	Mechatronics Engineering and Management (Co-op)	3		3	3.3
	Nuclear Engineering	52	3	55	46.6
	Nuclear Engineering (Co-op)	254	1	255	225.4
	Pre-Engineering	4	53	57	8.1
	Software Engineering	91	9	100	83.3
	Software Engineering (Co-op)	427	11	438	364.7
	Software Engineering and Management	2		2	1.4
Software Engineering and Management (Co-op)	1		1	1.4	
	Engineering and Applied Science Total	2,751	159	2,910	2436.8

Undergraduate Students and Fiscal Full-time Equivalents (FTEs) by Faculty, Program and Full-Time (FT)/Part-Time (PT) Status, 2025-2026 (Continued)

Faculty	Program	FT	PT	Total	FTEs
Faculty of Health Sciences	Allied Health Sciences	116	95	211	141.6
	Health Administration	39	2	41	41.0
	Health Sciences	475	16	491	477.5
	Kinesiology	362	7	369	355.9
	Kinesiology (Advanced Standing Option)	29	1	30	29.5
	Medical Laboratory Science	158	6	164	145.1
	Nursing (Collaborative)	899	17	916	852.5
	Nursing (Post-RPN)	168	10	178	164.6
	Nursing (Post-RPN) - Georgian College	37		37	32.5
		Health Sciences Total	2,283	154	2,437
Faculty of Science	Applied & Industrial Math	4		4	4.2
	Applied & Industrial Math (Co-op)	1		1	0.4
	Biological Science	246	14	260	234.4
	Biological Science (Co-op)	171	3	174	163.2
	Biological Science & Management (Co-op)	1		1	0.9
	Chemistry	50	6	56	47.4
	Chemistry (Co-op)	43		43	39.1
	Computer Science	260	22	282	239.1
	Computer Science (Co-op)	664	23	687	576.4
	Forensic Science	145	2	147	135.0
	Integrated Math & Computer Science	11	3	14	12.9
	Integrated Math & Computer Science (Co-op)	33		33	30.0
	Neuroscience	29		29	26.9
	Neuroscience (Co-op)	20		20	18.9
	Mathematics for Science & Industry	8		8	6.4
	Mathematics for Science & Industry (Co-op)	8		8	7.8
	Physics	37	4	41	38.8
	Physics (Co-op)	27	1	28	23.3
	Science Total	1,757	79	1,836	1605.1

Undergraduate Students and Fiscal Full-time Equivalents (FTEs) by Faculty, Program and Full-Time (FT)/Part-Time (PT) Status, 2025-2026 (Continued)

Faculty	Program	FT	PT	Total	FFTEs
Faculty of Social Science and Humanities	Communications and Digital Media Studies	106	8	114	98.6
	Communications and Digital Media Studies (Co-op)	8		8	6.7
	Criminology and Justice	313	21	334	318.3
	Criminology and Justice (Co-op)	44		44	40.1
	Forensic Psychology	267	16	283	261.0
	Legal Studies	105	7	112	105.2
	Legal Studies (Co-op)	13		13	12.6
	Liberal Studies	6	1	7	7.8
	Political Science	71	4	75	71.1
	Political Science (Co-op)	7		7	6.2
	Psychology (BA)	204	7	211	193.7
	Psychology (BSc)	41	1	42	39.6
	Social Science and Humanities Total	1,185	65	1,250	1160.9
Undeclared	Exchange Student	13		13	8.5
	Not Applicable		4	4	1.2
	Undeclared Total	13	4	17	9.7
	Grand Total	11,655	807	12,462	11,218.0



Graduate Students and Full-time Equivalents (FTEs) by Faculty, Program, Degree and Full-time (FT)/Part-time (PT) Status, 2025-2026

Faculty	Program	Degree	FT	PT	Total	FTEs
Faculty of Business and Information Technology	Business Analytics and AI	MBAI	73	11	84	76.3
	IT Security	MITS	177	9	186	179.7
	Financial Data Analytics	MFDA	53		53	53.0
	Cybersecurity	PHD	4	4	8	5.2
	Business and Information Technology Total			307	24	331
Frazer Faculty of Education	Education	MA	9	13	22	12.9
		MED	135	94	229	163.2
		EDD	51		51	51.0
	Education and Digital Technologies	DIPL	7	5	12	8.5
	Education Total			202	112	314
Faculty of Engineering and Applied Science	Automotive Engineering	MASC	3	1	4	3.3
		MENG	13		13	13.0
	Electrical and Computer Engineering	MASC	16	2	18	16.6
		MENG	40		40	40.0
		PHD	28	5	33	29.5
	Engineering Management	MENGM	64		64	64.0
	Mechanical Engineering	MASC	38	7	45	40.1
		MENG	27	1	28	27.3
		PHD	33	4	37	34.2
	Mechatronics Engineering	MASC	7	1	8	7.3
		MENG	8		8	8.0
	Nuclear Engineering	MASC	13	11	24	16.3
		MENG	8	3	11	8.9
		PHD	8	10	18	11.0
	Nuclear Engineering - UNENE	MENG		8	8	2.4
Operation and Maintenance	DIPL		3	3	0.9	
Software Engineering	MASC	15	2	17	15.6	
	MENG	69		69	69.0	

Graduate Students and Full-time Equivalents (FTEs) by Faculty, Program, Degree and Full-time (FT)/Part-time (PT) Status, 2025-2026 (Continued)

Faculty	Program	Degree	FT	PT	Total	FTEs
	Engineering and Applied Science Total		390	58	448	407.4
Faculty of Health Sciences	Health Sciences	MHSC	33	6	39	34.8
		PHD	27	11	38	30.3
	Nursing	MSCN	5	17	22	10.1
	Health Sciences Total		65	34	99	75.2
Faculty of Science	Applied Bioscience	MSC	16		16	16.0
		PHD	15		15	15.0
	Computer Science	MSC	49	1	50	49.3
		PHD	19	6	25	20.8
	Materials Science	MSC		1	1	0.3
		PHD	8		8	8.0
	Modelling and Computational Science	MSC	5	1	6	5.3
		PHD	3	1	4	3.3
	Science Total		115	10	125	118.0
Faculty of Social Science and Humanities	Criminology	MA	16	2	18	16.6
	Criminology and Social Justice	PHD	16		16	16.0
	Forensic Psychology	MSC	15	1	16	15.3
		PHD	14	1	15	14.3
	Social Practice & Innovation	MA	10		10	10.0
	Social Science and Humanities Total		71	4	75	72.2
Undeclared	Exchange Student		1		1	1.0
	Undeclared Total		1		1	1.0
	Grand Total		1,151	242	1,393	1,223.6

Undergraduate Student Headcount by Year of Study, 2025-2026

Faculty	Headcount				
	Year 1	Year 2	Year 3	Year 4+	Total
Faculty of Business and Information Technology	757	620	631	535	2,543
Frazer Faculty of Education	415	371	410	273	1,469
Faculty of Engineering and Applied Science	926	661	605	718	2,910
Faculty of Health Sciences	614	563	594	666	2,437
Faculty of Science	466	470	472	428	1,836
Faculty of Social Science and Humanities	320	234	327	369	1,250
Undeclared	14		1	2	17
Grand Total	3,512	2,919	3,040	2,991	12,462

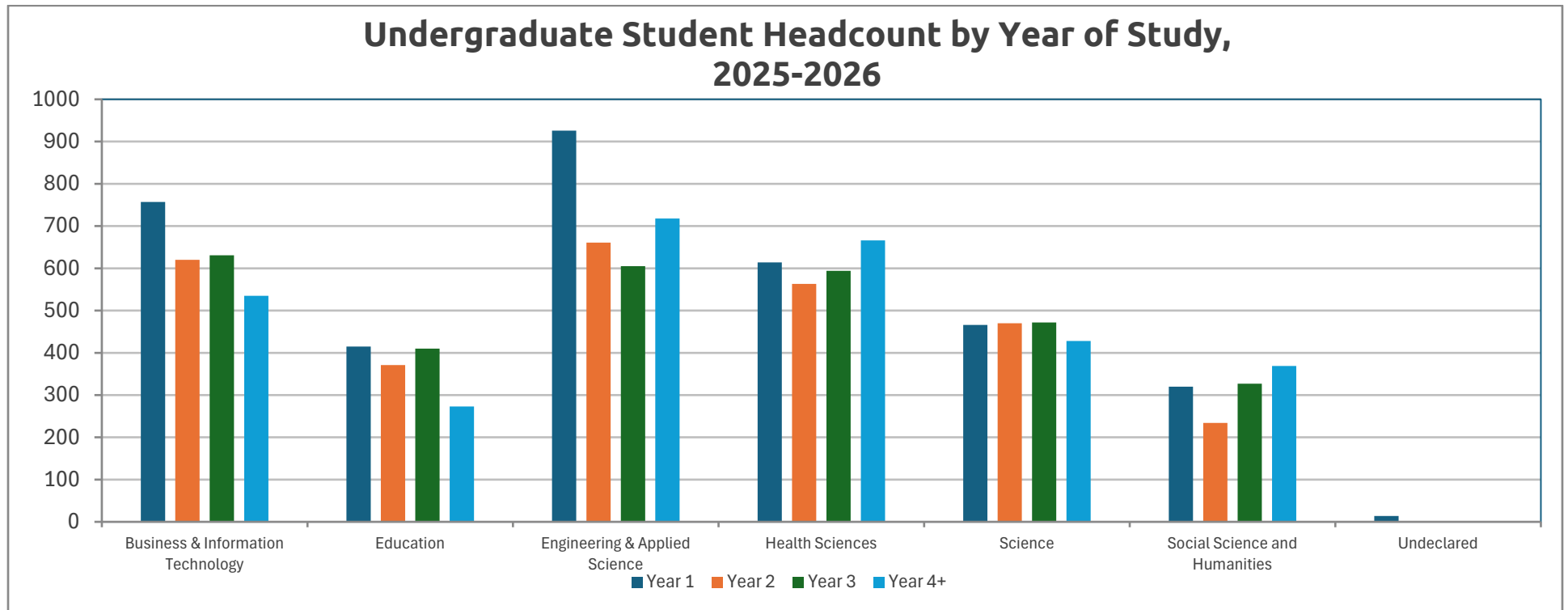

Student Count by Faculty and Residency, 2025-2026

Faculty	Undergraduate			Graduate			Grand Total	
	Domestic	International	% Int'l	Domestic	International	% Int'l	All	% Int'l
Faculty of Business and Information Technology	2,349	194	7.6%	83	248	74.9%	2,874	15.4%
Frazer Faculty of Education	1,468	1	0.1%	280	34	10.8%	1,783	2.0%
Faculty of Engineering and Applied Science	2,559	351	12.1%	147	301	67.2%	3,358	19.4%
Faculty of Health Sciences	2,340	97	4.0%	97	2	2.0%	2,536	3.9%
Faculty of Science	1,613	223	12.1%	77	48	38.4%	1,961	13.8%
Faculty of Social Science and Humanities	1,201	49	3.9%	69	6	8.0%	1,325	4.2%
Undeclared	4	13	76.5%		1	100.0%	18	77.8%
Grand Total	11,534	928	7.4%	753	640	45.9%	13,855	11.3%

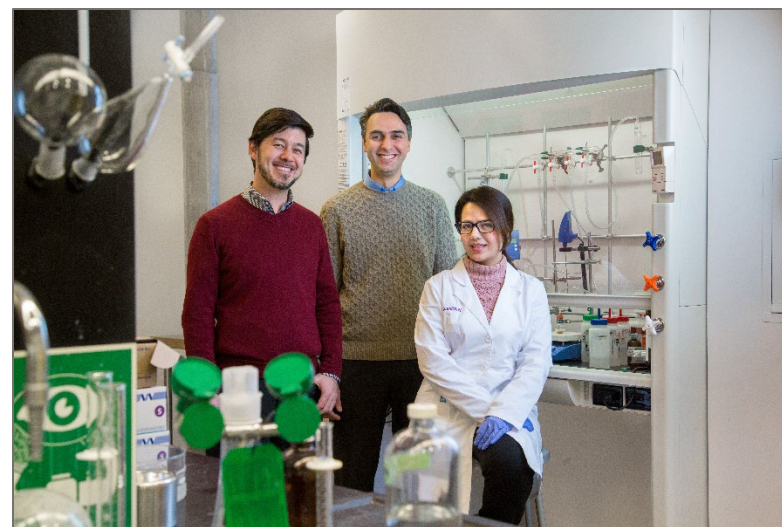

Students

All data summarizes official student enrolment as reported by Ontario Tech University to the Ontario Ministry of Colleges and Universities, which has a count date of November 1 each academic year. Students pursuing more than one degree are counted within their major field of study. The methodology used in calculating all counts is considered true as of the date of publication. During 2022-2023, in order to better align disciplines and combine expertise, the Faculty of Energy Systems and Nuclear Science was integrated into the Faculty of Engineering and Applied Science as a department. Faculty-level data provided from 2023-2024 and beyond reflects this change.



Undergraduate Student Demographics

	2021-2022	2022-2023	2023-2024	2024-2025	2025-2026
Gender					
Female	4,230	4,211	4,589	4,888	5,471
% Female	42%	42%	43%	43%	44%
Enrolment Status					
Full-time	9,354	9,338	10,006	10,550	11,655
Part-Time	668	699	675	719	807
% Part-Time	7%	7%	6%	6%	6%
Residency					
Domestic	9,249	9,185	9,746	10,418	11,534
International	773	852	935	851	928
% International	8%	8%	9%	8%	7%
Total	10,022	10,037	10,681	11,269	12,462

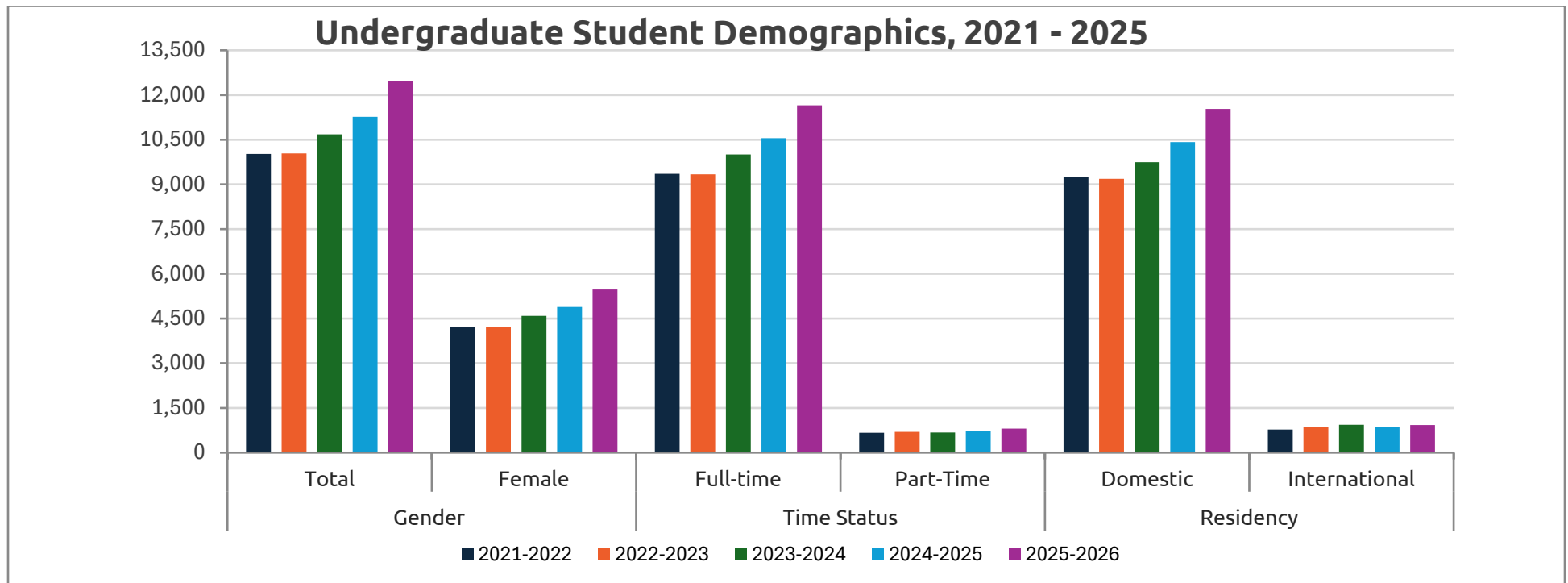

Graduate Student Demographics

	2021-2022	2022-2023	2023-2024	2024-2025	2025-2026
Gender					
Female	448	475	526	596	678
% Female	47%	47%	53%	51%	49%
Enrolment Status					
Full-time	680	756	738	902	1,151
Part-Time	267	261	259	280	242
% Part-Time	28%	26%	26%	24%	17%
Residency					
Domestic	639	617	639	720	753
International	308	400	358	462	640
% International	33%	39%	36%	39%	46%
Total	947	1,017	997	1,182	1,393

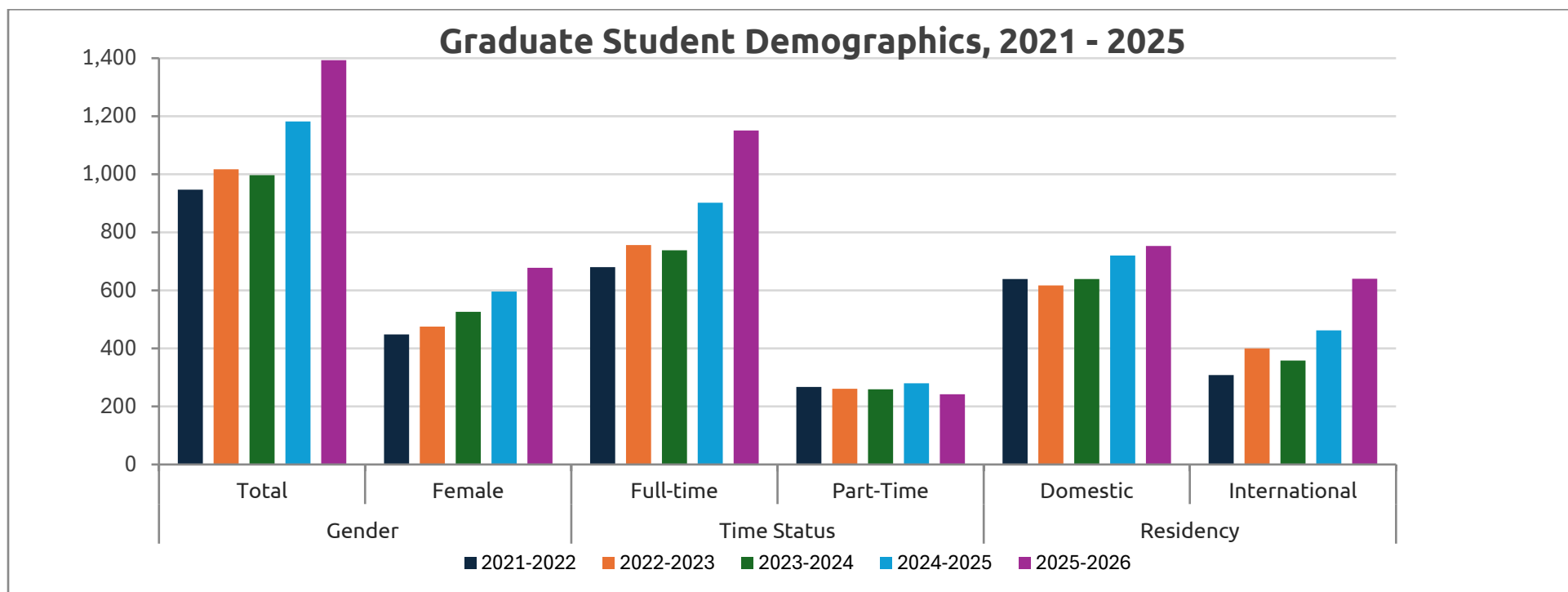

Undergraduate Student Count by Faculty

Faculty	2021-2022	2022-2023	2023-2024	2024-2025	2025-2026
Faculty of Business and Information Technology	2,061	2,056	2,196	2,278	2,543
Frazer Faculty of Education	492	609	835	1,148	1,469
Faculty of Energy Systems and Nuclear Science*	220	201			
Faculty of Engineering and Applied Science	2,130	2,130	2,436	2,486	2,910
Faculty of Health Sciences	2,126	2,093	2,176	2,267	2,437
Faculty of Science	1,436	1,529	1,669	1,791	1,836
Faculty of Social Science and Humanities	1,468	1,345	1,291	1,193	1,250
Undeclared	89	74	78	106	17
Total	10,022	10,037	10,681	11,269	12,462

*As of 2023-2024, included in Faculty of Engineering and Applied Science

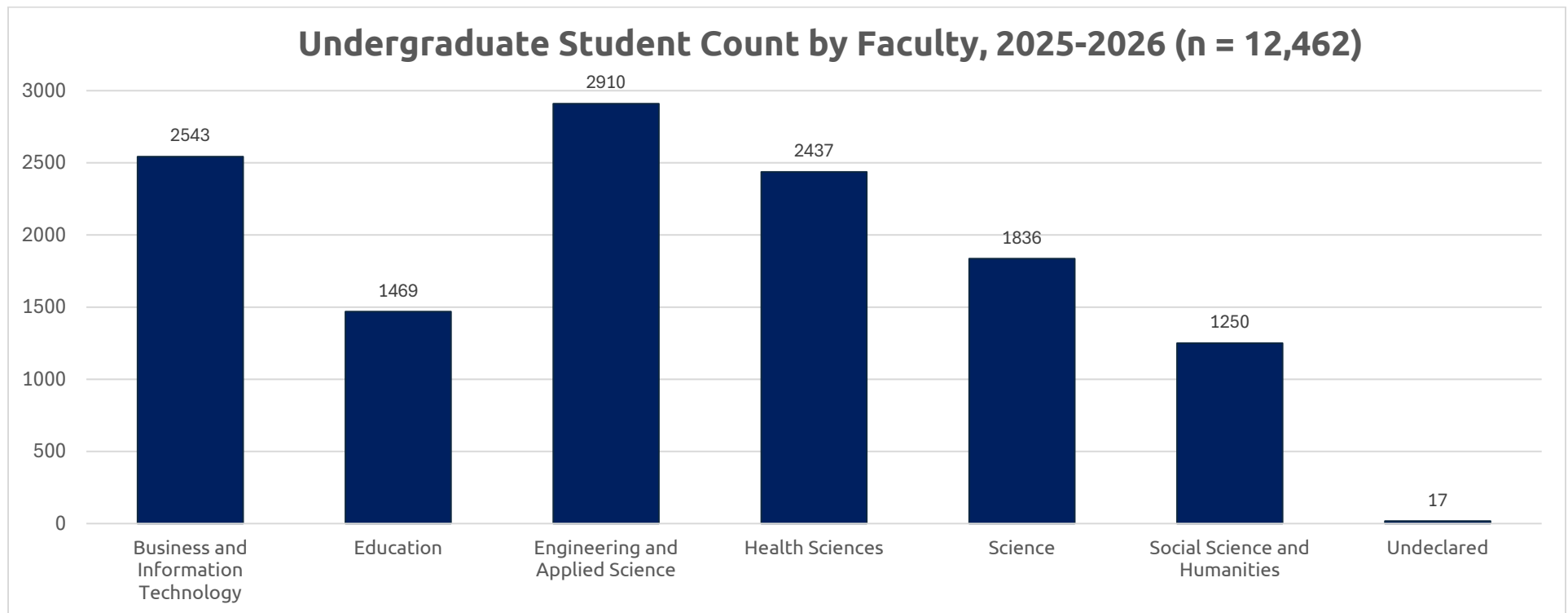

Graduate Student Count by Faculty

Faculty	2021-2022	2022-2023	2023-2024	2024-2025	2025-2026
Faculty of Business and Information Technology	118	165	114	202	331
Frazer Faculty of Education	188	187	218	270	314
Faculty of Energy Systems and Nuclear Science*	78	68			
Faculty of Engineering and Applied Science	231	282	349	385	448
Faculty of Health Sciences	123	104	102	107	99
Faculty of Science	139	142	139	130	125
Faculty of Social Science and Humanities	70	68	70	88	75
Undeclared	0	1	5	0	1
Total	947	1,017	997	1,182	1,393

*As of 2023-2024, included in Faculty of Engineering and Applied Science

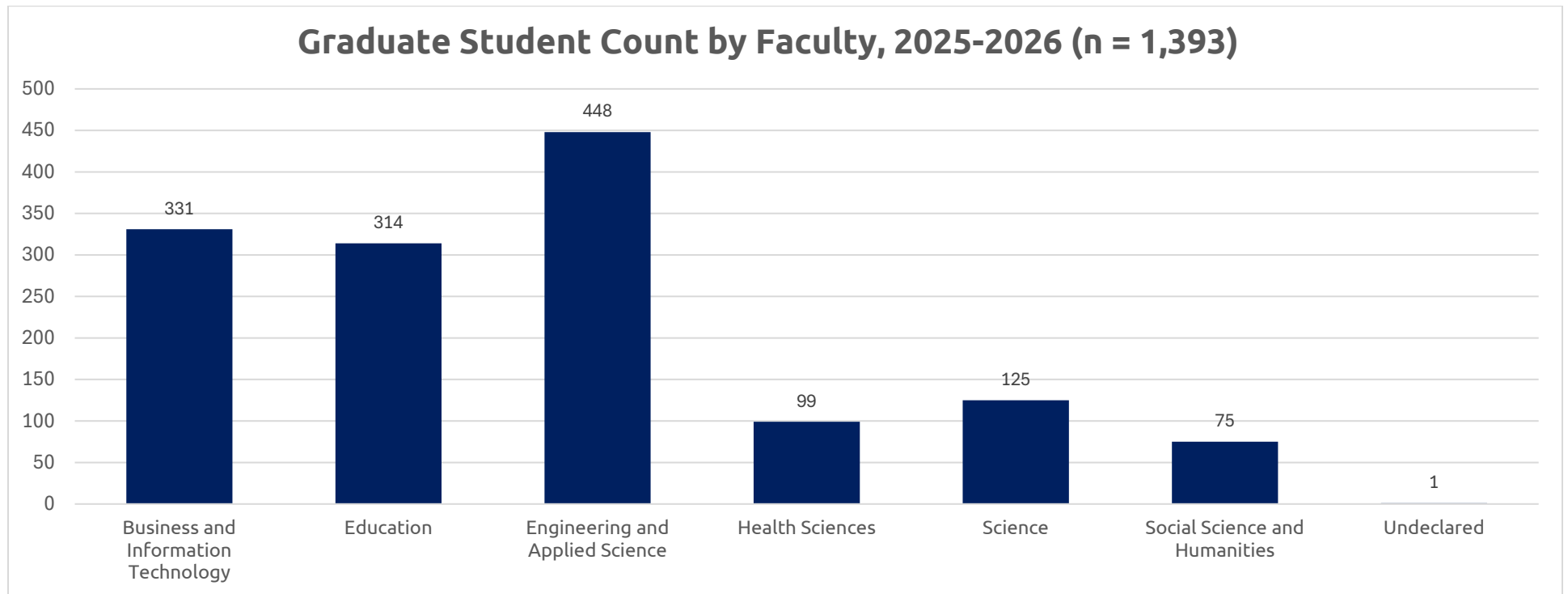

Undergraduate FTEs by Faculty

Faculty	2021-2022	2022-2023	2023-2024	2024-2025	2025-2026
Faculty of Business and Information Technology	1,882.7	1,855.9	1,987.7	2,053.9	2,300.4
Frazer Faculty of Education	457.0	577.6	824.5	1,136.2	1,464.9
Faculty of Energy Systems and Nuclear Science*	169.6	150.6	-	-	-
Faculty of Engineering and Applied Science	1,744.7	1,673.7	2,042.8	2,102.5	2,436.8
Faculty of Health Sciences	1,901.3	1,850.2	1,925.9	2,059.8	2,240.1
Faculty of Science	1,255.2	1,343.4	1,494.4	1,604.6	1,605.1
Faculty of Social Science and Humanities	1,327.1	1,227.2	1,151.1	1,089.4	1,160.9
Undeclared	40.0	42.0	44.1	57.8	9.7
Grand Total	8,777.7	8,720.6	9,470.5	10,104.2	11,218.0

*As of 2023-2024, included in Faculty of Engineering and Applied Science

Graduate FTEs by Faculty

Faculty	2021-2022	2022-2023	2023-2024	2024-2025	2025-2026
Faculty of Business and Information Technology	114.5	155.2	102.1	187.3	314.2
Frazer Faculty of Education	100.5	106.5	133.3	188.1	235.6
Faculty of Energy Systems and Nuclear Science*	54.2	42.1	-	-	-
Faculty of Engineering and Applied Science	213.5	261	306.3	333.2	407.4
Faculty of Health Sciences	83.8	77.4	81.0	80.4	75.2
Faculty of Science	125.7	126.6	122.2	118.1	118.0
Faculty of Social Science and Humanities	67.9	64.5	65.8	78.9	72.2
Undeclared	0	1.0	5.0	0	1.0
Grand Total	760.1	834.3	815.7	986	1,223.6

*As of 2023-2024, included in Faculty of Engineering and Applied Science

Age Distribution of Students

Age	2021-2022	2022-2023	2023-2024	2024-2025	2025-2026
Under 20	3,027	3,304	3,754	3,883	4,092
20 to 24	5,537	5,318	5,374	5,793	6,619
25 to 29	1,216	1,253	1,259	1,296	1,476
30 to 34	443	442	494	571	632
35 to 39	297	305	313	349	413
40 and over	403	432	484	559	623
Overall	10,968	11,054	11,678	12,451	13,855

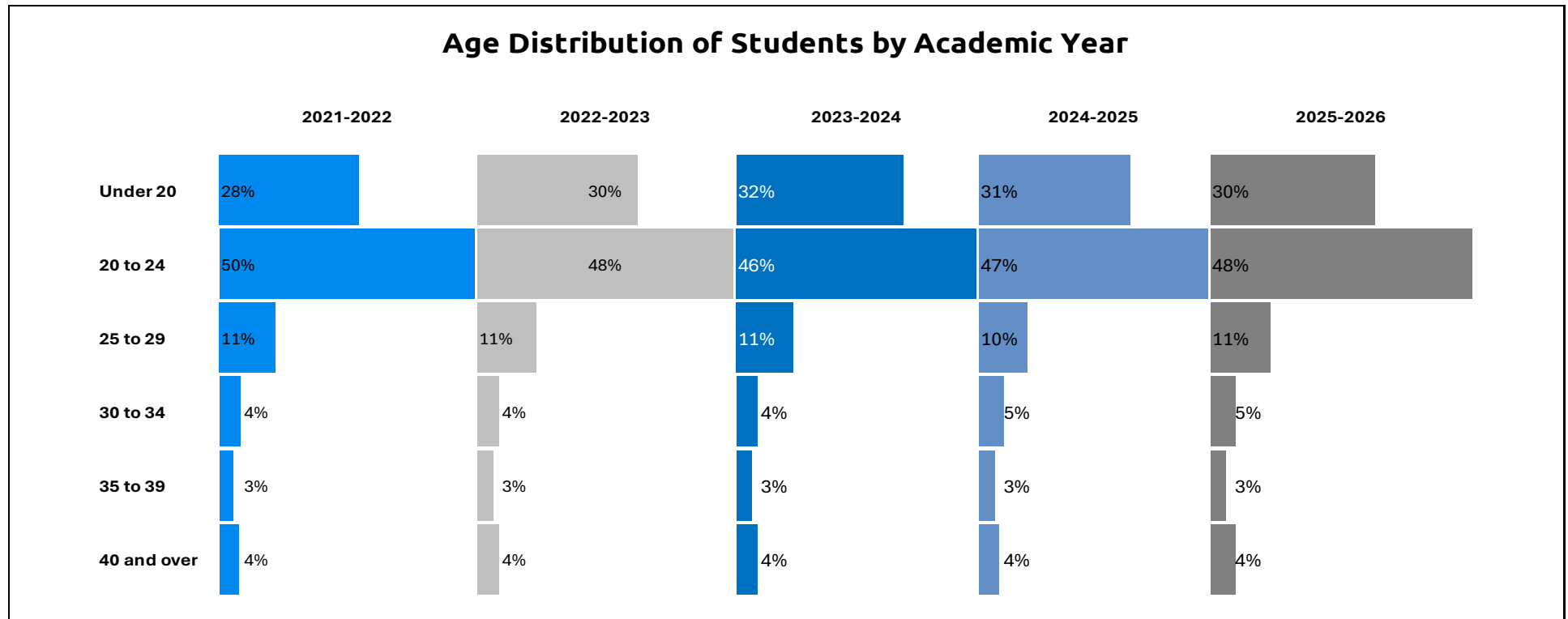

New Student Admission Averages

Faculty	2021-2022	2022-2023	2023-2024	2024-2025	2025-2026
Faculty of Business and Information Technology	81.9	81.8	79.4	79.4	78.7
Frazer Faculty of Education*	-	-	82.4	81.1	82.4
Faculty of Energy Systems and Nuclear Science**	85.3	82.4	-	-	-
Faculty of Engineering and Applied Science	83.5	83.8	82.1	81.5	81.2
Faculty of Health Sciences	86.5	85.3	82.4	81.4	81.3
Faculty of Science	85.9	85.9	85.6	82.9	81.2
Faculty of Social Science and Humanities	82.7	82.4	79.5	78.8	78.0
Undeclared	-	-	-	-	-
Overall Average	84.2	84.0	82.0	81.1	80.5

* Prior to 2023-2024, there were no 101 admissions for Education, hence there were no admission averages to report for this Faculty.

**As of 2023-2024, included in Faculty of Engineering and Applied Science

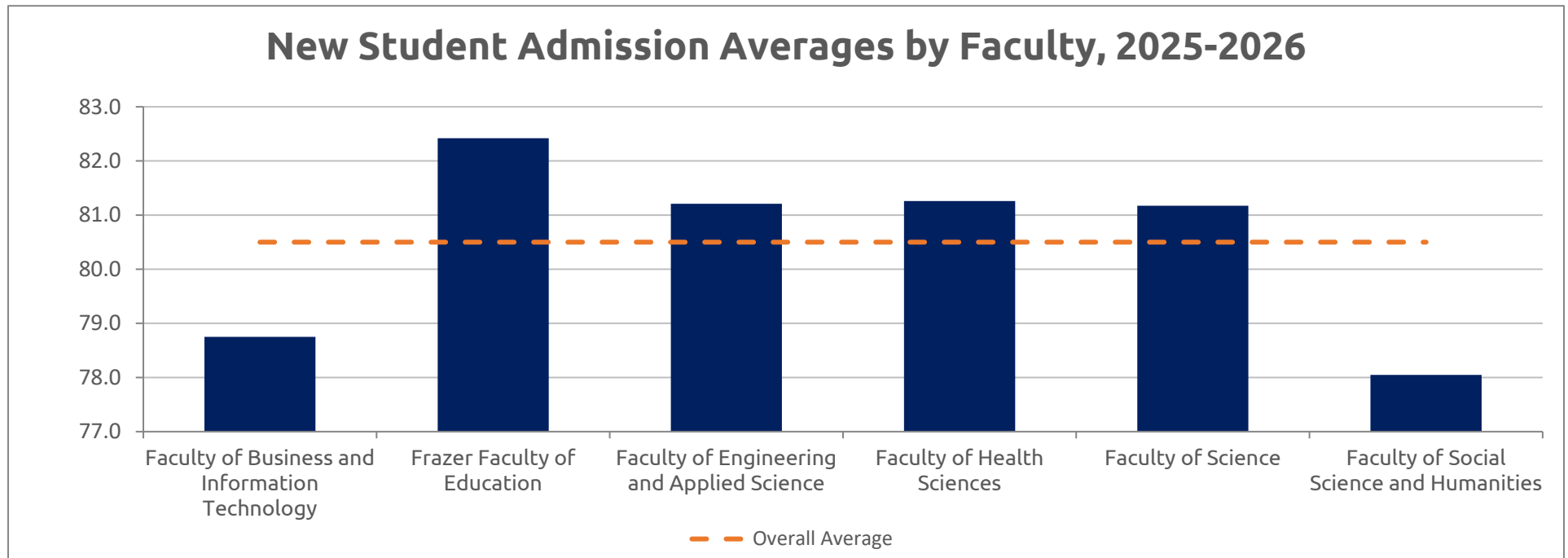

New Student Applications from Ontario High Schools and Yield Rates

Year	2021-2022	2022-2023	2023-2024	2024-2025	2025-2026
Applicant	6,248	7,844	9,294	10,248	10,103
Admission	5,784	7,048	8,130	9,381	9,626
Confirmation	1,433	1,619	1,778	1,828	2,005
Registration	1,415	1,591	1,741	1,806	2,005
Admission Rate (Admission/ Applicant)	0.93	0.90	0.87	0.91	0.95
Confirmation Rate (Confirmation/ Admission)	0.25	0.23	0.22	0.18	0.20
Registration Rate (Registration/ Admission)	0.24	0.23	0.21	0.18	0.20

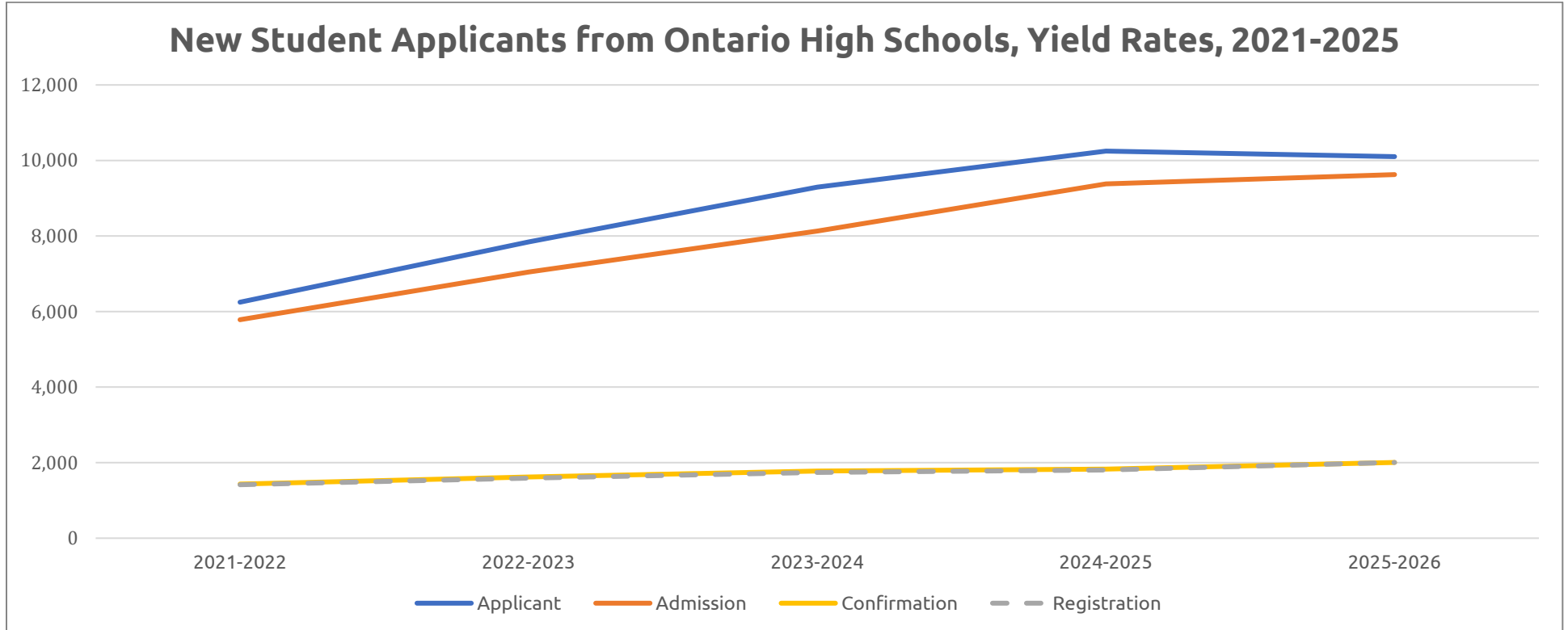

Distribution of First-year and Fourth-year Class Sizes

Distribution of First-year Class Sizes

Number of Students	2021-2022	2022-2023	2023-2024	2024-2025	2025-2026
Fewer than 30	26	18	16	17	24
30 to 60	44	47	49	39	33
61 to 100	39	29	29	47	33
101 to 250	39	52	56	52	64
Greater than 250	5	4	8	8	7
Total	153	150	158	163	161

Note: Distribution of class sizes aligns with CUDO data for all years prior to 2016/17. In 2016 (and moving forward), CUDO data excludes nursing classes. For the Ontario Tech University factbook, class size includes nursing classes and the totals are therefore slightly higher than the CUDO data.

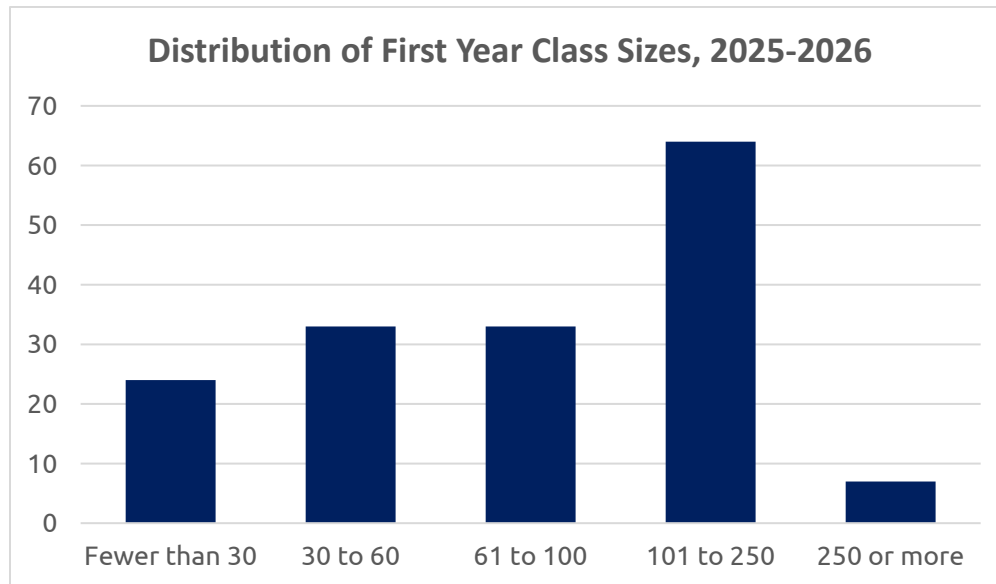

Distribution of Fourth-year Class Sizes

Number of Students	2021-2022	2022-2023	2023-2024	2024-2025	2025-2026
Fewer than 30	62	71	65	91	74
30 to 60	53	57	52	36	47
61 to 100	26	28	27	23	22
101 to 250	8	4	6	5	11
250 or more	1	0	0	0	0
Total	150	160	150	155	154

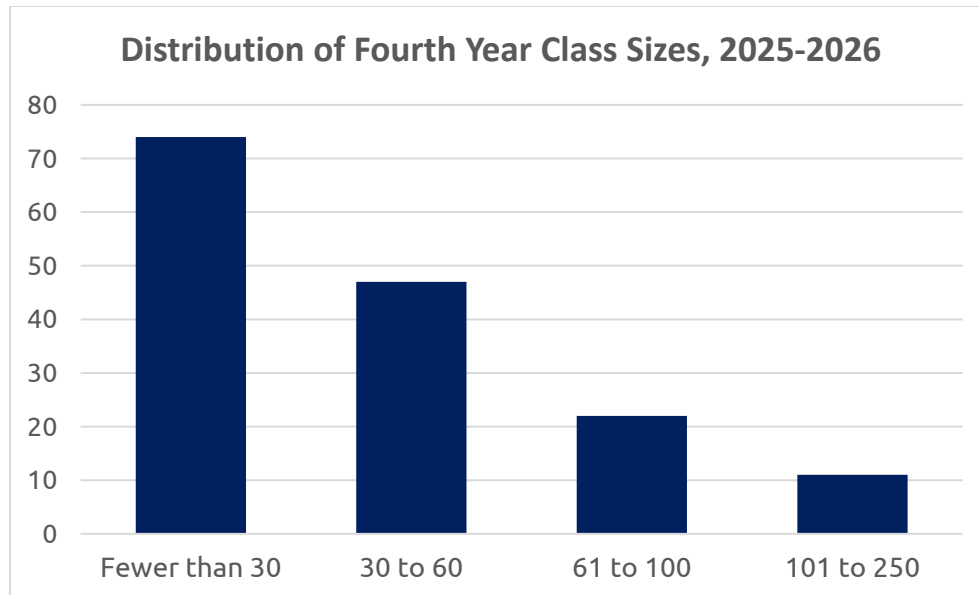

Degrees/Diplomas Granted

Degree	2021	2022	2023	2024	2025
Bachelor of Arts (Honours)	416	416	400	469	438
Bachelor of Allied Health Science (Honours)	20	24	26	30	56
Bachelor of Commerce (Honours)	317	291	263	245	244
Bachelor of Education (Consecutive)	183	130	195	182	201
Bachelor of Engineering & Management (Honours)	5	5	4	6	2
Bachelor of Engineering (Honours)	407	432	401	388	300
Bachelor of Health Science (Honours)	203	229	227	203	221
Bachelor of Information Technology	125	147	150	190	170
Bachelor of Science (Honours)	209	209	212	259	249
Bachelor of Science & Management (Honours)	2	2	3		1
Bachelor of Science in Nursing (Honours)	228	208	206	227	229
Master of Applied Science	41	40	37	54	37
Master of Arts	17	10	17	10	21
Master of Business Analytics and AI			6	18	48
Master of Education	58	57	57	74	90
Master of Engineering	36	40	55	41	34
Master of Engineering & Management	1	16	20	37	25
Master of Financial Data Analytics				1	8
Master of Health Science	16	32	23	16	24
Master of Information Technology Security	36	42	106	48	41
Master of Science	33	31	35	39	29
Master of Science in Nursing			4	4	8
PHD	35	28	24	34	50
Total	2,388	2,389	2,471	2,575	2,526

Degrees/Diplomas Granted (continued)

Undergraduate Diploma	2021	2022	2023	2024	2025
Public Policy			1	1	
Facilitating Adult Learning					1
Total			1	1	1

Graduate Diploma	2021	2022	2023	2024	2025
Accounting	16	18	16	19	18
Education & Digital Technologies	1	7	4	3	5
Fuel, Materials and Chemistry			1		
Health Physics			1		
Nuclear Design Engineering	1	2	1		1
Operation and Maintenance	8	1	1	3	2
Police Leadership					9
Radiological Applications		1			
Reactor Systems	1				
Safety, Licensing & Reg. Affa.	1			1	
Work Disability Prevention					
Total	28	29	24	26	35

Degrees and diplomas	2021	2022	2023	2024	2025
Grand Total	2,416	2,418	2,496	2,602	2,562



[Return to Table of Contents](#)

Total Degrees/Diplomas Conferred by Faculty

Total Degrees/Diplomas Conferred by Faculty, 2021-2025

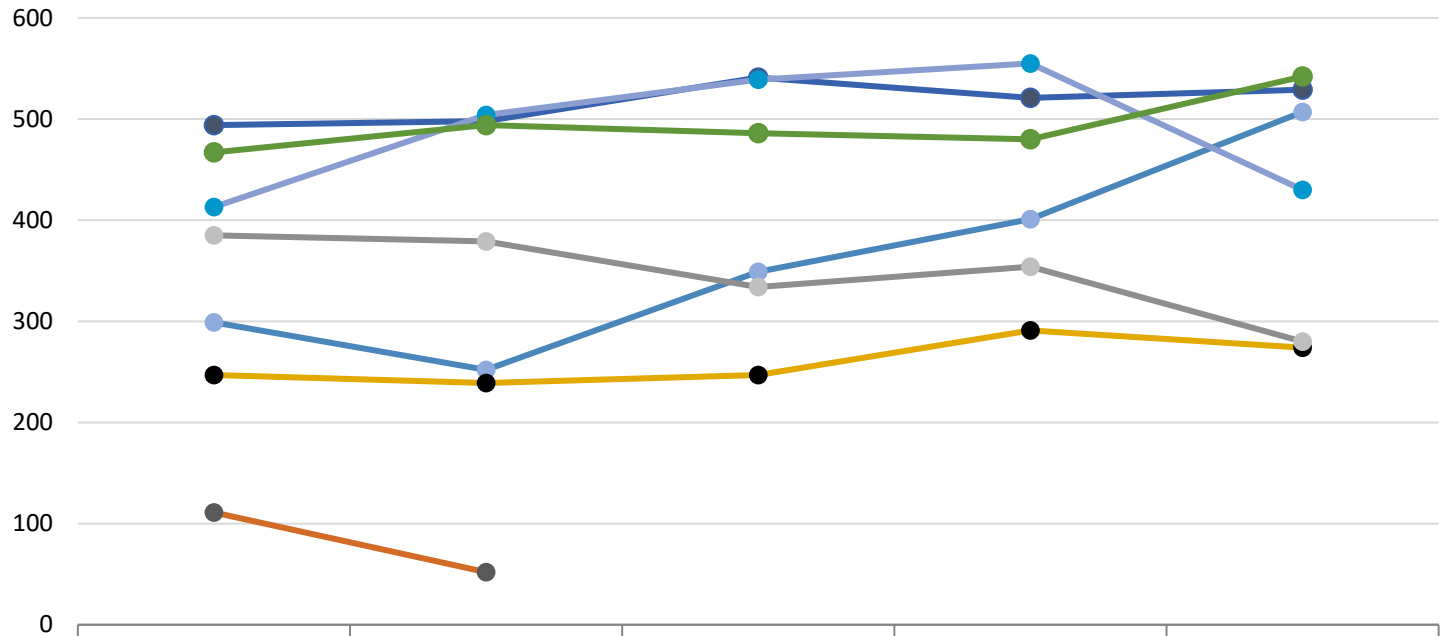

	2021	2022	2023	2024	2025
Business and Information Technology	494	498	541	521	529
Education	299	252	349	401	507
Energy Systems and Nuclear Science*	111	52			
Engineering and Applied Science	413	504	539	555	430
Health Sciences	467	494	486	480	542
Science	247	239	247	291	274
Social Science and Humanities	385	379	334	354	280
Total	2416	2418	2496	2602	2562

*As of 2023, included in Faculty of Engineering and Applied Science

Faculty and Staff

Faculty counts are summarized from reports submitted by Human Resources to Statistics Canada. All definitions follow those used in the original submission. Counts are based on faculty as of October 1 of the academic year. Percentages are rounded to the nearest whole number. The asterisk (*) denotes inclusion of 8 Durham College teaching faculty cross-appointed with Ontario Tech University. The methodology used in calculating all counts is considered true as of the date of publication.

Continuing Staff, 2025-2026

Classification	Total
Tenure/Tenure-Track Faculty (including three Academic Executives)	224
Teaching Faculty*	86
Limited Term Faculty Members	20
Senior Executives (non-academic)	4
Confidential, Professional and Managerial	182
Union	348
Total	864

*Includes 8 DC Faculty

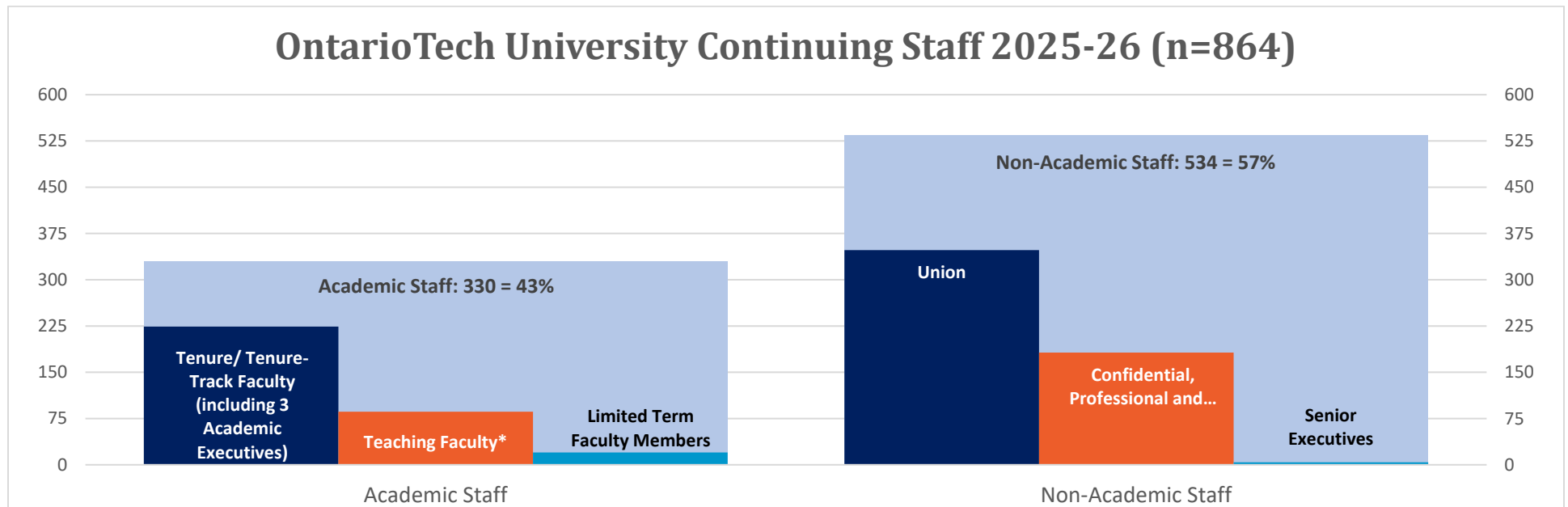

Tenure and Tenure-Track Faculty

Only academic administrators up to Deans are included in the following counts. Academic Executives (President, Provost, AVPs) are not included in faculty counts.

	2021-2022	2022-2023	2023-2024	2024-2025	2025-2026
Assistant Professor	34	29	30	31	30
Associate Professor	112	116	115	105	98
Full Professor	70	74	77	86	92
Total	216	219	222	222	220

*Includes Dean of Grad Studies

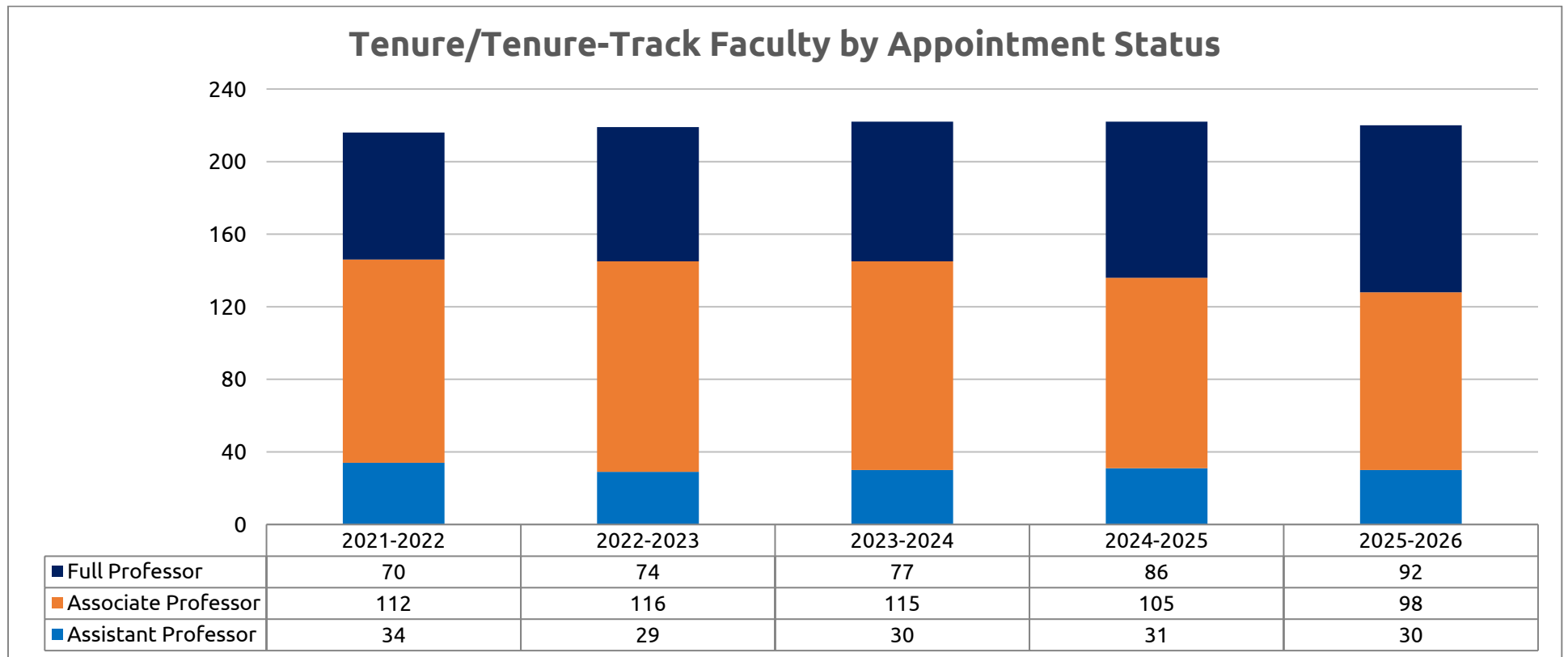

Tenure/Tenure-Track Faculty by Faculty and Rank

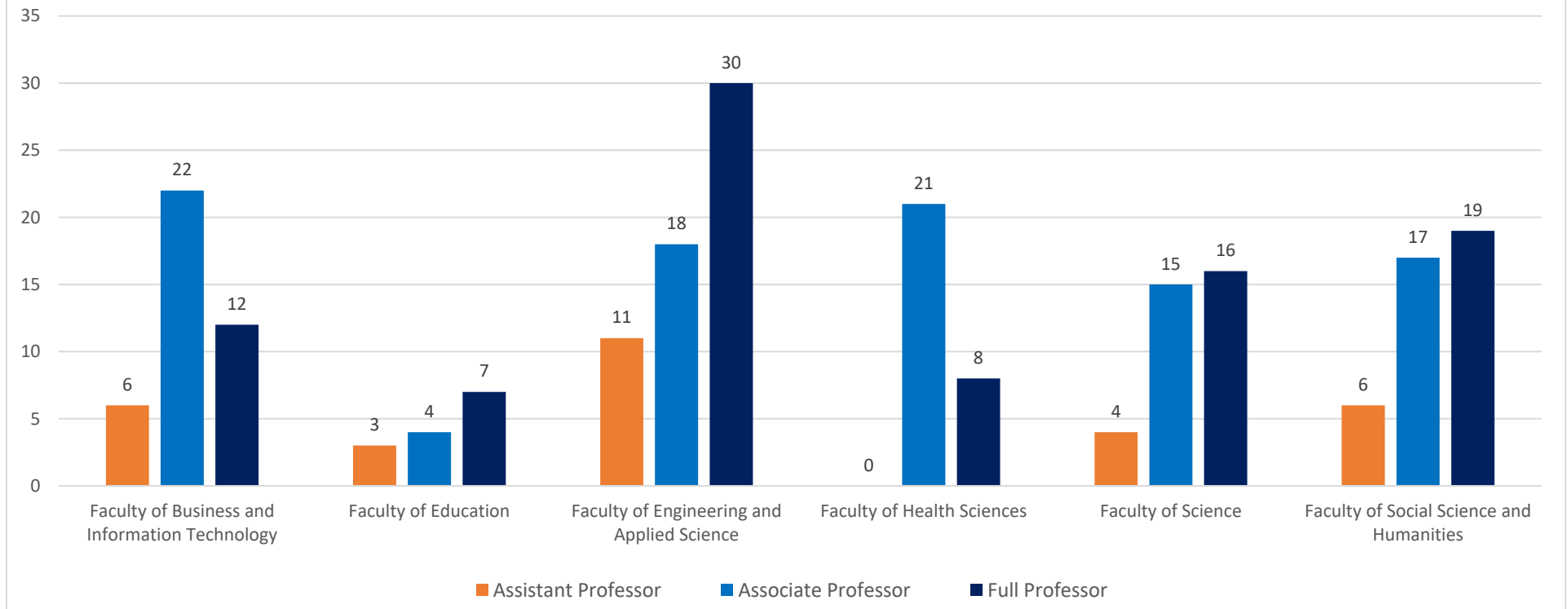

Tuition and Fees

Undergraduate Tuition and Fees (2025-2026 full-time fee schedule)

Tuition (Domestic)	Year 1	Year 2	Year 3	Year 4	Year 5
BA, BAsC, BEd, BHSc, BSc, BSc & Mgmt, UG Diploma	\$5,983	\$5,956	\$5,927	\$5,921	\$5,915
BSc & BSc & Mgmt (Computer Science, Integrated Math & Comp. Sci.)	\$7,876	\$7,876	\$7,876	\$6,322	\$6,322
BScN, BHA	\$6,101	\$6,095	\$6,089	\$6,083	
BCom	\$10,048	\$10,048	\$10,048	\$8,004	
BIT	\$9,031	\$9,022	\$9,014	\$8,992	
BEng, BEng & Mgmt	\$11,219	\$11,219	\$11,219	\$9,283	\$9,159
Tuition (Out of Province)	Year 1	Year 2	Year 3	Year 4	Year 5
BA, BAsC, BEd, BHSc, BSc, BSc & Mgmt, UG Diploma	\$6,926	\$6,895	\$6,861	\$6,854	\$6,847
BSc & BSc & Mgmt (Computer Science, Integrated Math & Comp. Sci.)	\$7,876	\$7,876	\$7,876	\$7,318	\$7,318
BScN, BHA	\$7,062	\$7,055	\$7,049	\$7,042	
BCom	\$10,048	\$10,048	\$10,048	\$9,265	
BIT	\$10,455	\$10,445	\$10,434	\$10,409	
BEng, BEng & Mgmt	\$11,219	\$11,219	\$11,219	\$10,746	\$10,603
Tuition (International)	Year 1	Year 2	Year 3	Year 4	Year 5
BA, BAsC, BEd, BHSc, BSc & Mgmt	\$33,154	\$33,154	\$33,154	\$33,154	\$27,524
BSc & BSc & Mgmt (Computer Science, Integrated Math & Comp. Sci.)	\$36,730	\$36,730	\$36,730	\$36,730	\$33,536
BScN, BHA	\$33,807	\$33,807	\$33,807	\$33,807	
BCom	\$36,774	\$36,774	\$36,774	\$36,774	
BIT	\$40,916	\$40,916	\$40,916	\$40,916	
BEng, BEng & Mgmt	\$45,205	\$45,205	\$45,205	\$45,205	\$41,274

Tuition and Fees (Continued)

Graduate – Program Based Tuition and Fees (2025-2026 full-time fee schedule)

Tuition (Domestic)	All Years
MA (Crim, SPI), MHSc, MSc & MSc (Computer Science)	\$7,579
MASc	\$7,860
MSc (Nursing)	\$8,762
EdD	\$10,097
PhD	\$7,579
Diploma in Accounting	\$9,849
Diploma in Nuclear Technology, Engineering Management, Nuclear Design Engineering	\$5,907
Tuition (International)	All Years
MA (Crim, SPI), MHSc, MSc & MSc (Computer Science)	\$20,124
MASc	\$22,313
MSc (Nursing)	\$26,900
EdD	\$20,113
PhD	\$19,166
Diploma in Accounting	\$15,440
Diploma in Nuclear Technology, Engineering Management, Nuclear Design Engineering	\$22,350

Graduate - Credit Based Tuition and Fees

Tuition (Domestic)	Per 3 Credit Course
MEd, MA (Education)	\$1,576
Diploma in Ed & Digital Technology, Police Leadership, Work Disability Prevention	\$1,576
MITS	\$1,258
MEng, MEngM	\$1,477
MBAI, MFDA	\$2,709
Tuition (International)	Per 3 Credit Course
MEd, MA (Education)	\$3,013
Diploma in Ed & Digital Technology, Police Leadership, Work Disability Prevention	\$3,013
MITS	\$4,604
MEng, MEngM	\$4,470
MBAI, MFDA	\$5,209

Ancillary Fees

Flat Fees. FT and PT students.	Annual Fee
Career Readiness	46.82
Health Services (general)	29.85
Mental Health Services	73.08
Health and Wellness	16.70
Sport and Recreation	100.50
Campus Open Access	94.19
Student Safety and Accessibility	36.95
Student Success Support	34.65
Physical & Virtual Infrastructure Enhancements	168.39
Student ID	40.72
Charged to FT each term	
U-Pass	320.68
Flat Fees Paid half Fall and half Winter. FT and PT students.	
Community and Social Programming	13.70
Wellness and Support Services	12.50
Student Representation and Leadership	10.56
World University Services of Canada	3.02
Campus Clubs	5.77
Student Societies	3.66
Student Society Fee FBIT	14.53
Student Society Fee FEAS	20.02
Student Society Fee FHSc	10.72
Student Society Fee FSCI	16.07
Student Society Fee FSSH	7.88
Campus Life and Events	14.05
Student Engagement	60.72
Student Learning	94.88
Convocation	7.40
Instructional Resource	154.87



Ancillary Fees (Continued)

Flat Fees Paid half Fall and half Winter. FT and PT students.	
Georgian Engagement Services	223.79
Technology-enriched Learning FSCI	166.05
Technology-enriched Learning FHSc	171.19
Technology-enriched Learning FEAS	212.97
Technology-enriched Learning FBIT Non-Gaming	163.83
Technology-enriched Learning FBIT -Gaming	362.89
Technology-enriched Learning FSSH	141.73
Technology-enriched Learning FEDU	240.15
Technology-enriched Learning Undeclared	167.01
Student Life Admin	37.60
Student Life Communications	41.35
OUSA Membership Fee	3.65
Flat Fees Paid half Fall and half Winter. FT only	
Benefit Plan Coordination	25.62
USU Building	119.00
Campus Recreation and Wellness Centre	185.42
Varsity Sports	86.66
Flat Fees Paid once per yr. (Fall or as admitted). FT only.	
Health & Dental - Fall	305.00
Health & Dental - Winter	247.00
Health & Dental -Summer	188.97
Legal Protection Program - Fall	33.24
Legal Protection Program – Winter/Summer	22.16
International Health Insurance - Fall	756.00
International Health Insurance - Winter	504.00
International Health Insurance - Summer	252.00
My Virtual Doctor	44.07

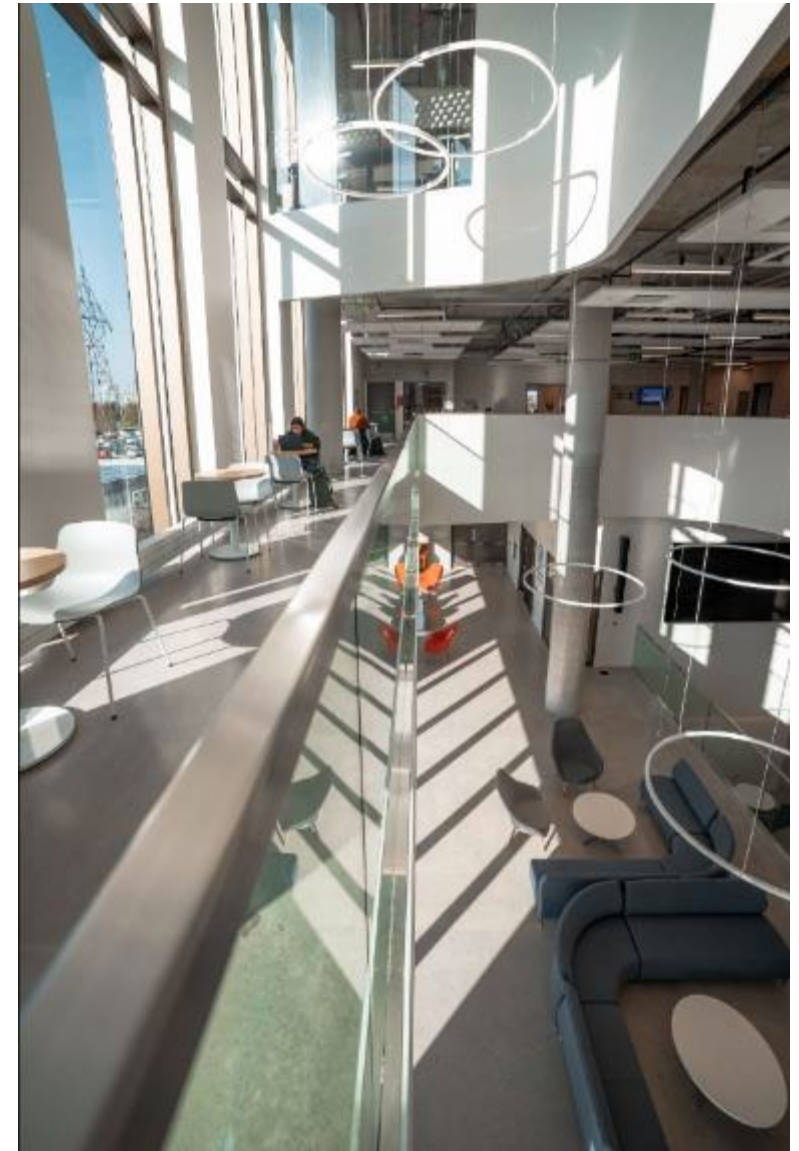

Ancillary Fees (Continued)

Flat Fees Paid once per yr. (Fall or as admitted). FT and PT students.	
Nursing Levy for CNSA	10.72
Graduate Diploma in Accounting	267.90
Flat Fees Paid at time of Course Registration	
Internship/Coop	734.40
Internship Fee (FBIT/FEAS only)	918.00
Business - INFR 2421U	10.72
Business - BUSI 4701U	5.36
Medical Laboratory Fee - MLSC 1010U	65.52
Medical Laboratory Mask Fee - MLSC 4400U	48.22
Nursing Lab Supply Fee - NURS 1003U	54.59
Nursing Lab Supply Fee - NURS 2810U	32.75
Nursing Lab Supply Fee - NURS 2820U	54.59
Nursing - Licensure Form Completion	107.16
Nursing – Synergy	51.51
Kinesiology Lab Supply Fee - HLSC 3476U	21.84
Kinesiology Lab Supply Fee - HLSC 3475U	10.91
Flat Fee Paid Per Term (4 Terms)	
Education Placement Fee	153.00



Student Financial Aid and Scholarships

Amounts are in Canadian dollars. Data is provided by the Student Awards and Financial Aid office.

Student Scholarships and Awards, 2025-2026

Admission Scholarships	First Year Awards		Renewable		Total	
	Number	Amount	Number	Amount	Number	Amount
Chancellor's Scholarship (\$9,000/year for four years)	1	\$9,000	3	\$27,000	4	\$36,000
President's Scholarship (\$7,500/year for four years)	2	\$15,000	5	\$37,500	7	\$52,500
Founder's Scholarship (\$6,000/year for four years)	2	\$12,000	4	\$24,000	6	\$36,000
First Robotics Scholarship (\$3,000/year for four years)	1	\$3,000	3	\$9,000	4	\$12,000
Global Leadership Award (\$30,000/year for four years)	1	\$30,000	3	\$90,000	4	\$120,000
Total	7	\$69,000	18	\$187,500	25	\$256,500

Awards of Recognition	First Year Awards	
	Number	Amount
95.0% - 100% = \$4,000 (First year award only)	28	\$112,000
90.0% - 94.9% = \$2,000 (First year award only)	181	\$362,000
85% - 89.9% = \$1,000 (First year award only)	302	\$302,000
Total	511	\$776,000

In-Course Scholarships	Non-Renewable	
	Number	Amount
4.0 - 4.3 GPA = \$1,500	333	\$499,500
3.7 - 3.9 GPA = \$1,000	606	\$606,000
Total	939	\$1,105,500



Student Scholarships and Awards (continued)

Athletic Scholarships	First Year Awards		Renewable		Total	
	Number	Amount	Number	Amount	Number	Amount
\$5,000 (renewable in 2nd, 3rd, and 4th year)	12	\$60,000	23	\$115,000	35	\$175,000
\$4,500 (renewable in 2nd, 3rd, and 4th year)	0	\$0	7	\$31,500	7	\$31,500
\$4,000 (renewable in 2nd, 3rd and 4th year)	2	\$8,000	5	\$20,000	7	\$28,000
\$3,500 (renewable in 2nd, 3rd and 4th year)	2	\$7,000	0	\$0	2	\$7,000
\$3,000 (renewable in 2nd, 3rd and 4th year)	1	\$3,000	9	\$27,000	10	\$30,000
\$2,500 (renewable in 2nd, 3rd and 4th year)	6	\$15,000	8	\$20,000	14	\$35,000
\$2,250 (renewable in 2nd, 3rd and 4th year)	0	\$0	0	\$0	0	\$0
\$2,000 (renewable in 2nd, 3rd and 4th year)	5	\$10,000	17	\$34,000	22	\$44,000
\$1,750 (renewable in 2nd, 3rd and 4th year)	0	\$0	1	\$1,750	1	\$1,750
\$1,500 (renewable in 2nd, 3rd and 4th year)	0	\$0	3	\$4,500	3	\$4,500
\$1,250 (renewable in 2nd, 3rd and 4th year)	0	\$0	0	\$0	0	\$0
\$1,000 (renewable in 2nd, 3rd and 4th year)	1	\$1,000	8	\$8,000	9	\$9,000
\$750 (renewable in 2nd, 3rd and 4th year)	1	\$750	0	\$0	1	\$750
\$500 (renewable in 2nd, 3rd and 4th year)	0	\$0	2	\$1,000	2	\$1,000
Total	30	\$104,750	83	\$262,750	113	\$367,500
Total Awards and Scholarships	548	\$949,750	101	\$450,250	1588	\$2,505,500



Student Financial Aid, 2025-2026

Type of Aid	Undergraduate	Graduate	Total Number
Total Nil Awards*	1,226	97	1,323
Total Canada Student Loan only	3,871	110	3,981
Total Ontario Student Loan only	24	0	24
Total Grant only	243	2	245
Total Canada and Ontario Student Loan	3,920	254	4,174
Total No. of OSAP applications on file	9,284	463	9,747

Type of Aid	Total Amount	Total Amount	Total Amount
Total Canada Student Loans Issued	\$44,047,978	\$2,300,625	\$46,348,603
Total Ontario Student Loans Issued	\$4,144,319	\$599,453	\$4,743,772
Total Grants	\$42,098,856	\$1,416,311	\$43,515,167
Total Funding Issued	\$90,291,153	\$4,316,389	\$94,607,542

*'Nil' awards are situations where a student's OSAP assessment results in no funding due to their financial resources exceeding or meeting their calculated costs.



Research

Amounts are in Canadian dollars. Data is provided by the Office of Research Services. Data is accurate to May 1, 2026.

Research Grants and Contracts by Faculty and by Source, 2025-2026

Faculty/School	Research Funding
Business and IT	\$2,100,090.22
Education	\$210,557.00
Engineering and Applied Science	\$6,503,195.57
Health Sciences	\$4,249,173.69
Science	\$2,539,196.20
Social Sciences & Humanities	\$984,817.00
Institutional	\$ 3,152,754.00
Brilliant Catalyst	\$ 1,462,657.36
Brilliant Energy Institute	\$ 152,059.00
Research Donations (Advancement)	\$1,014,616.13
ACE	\$7,258,189.31
Total Cash	\$29,703,746.48
Total In-Kind	\$833,408
TOTAL	\$30,537,154.48

Source	Research Funding
Tri-Council	
NSERC	\$4,793,126.00
SSHRC	\$725,561.00
CIHR	\$744,235.38
CFI	\$804,175.00
CRC	\$890,000.00
TIPS	\$0
Other Federal Government	\$3,994,929.02
Total Federal Government	\$11,952,026.40
MCU	\$812,524.00
OCE	\$381,000.00
Other Provincial Governments	\$1,369,964.82
Total Provincial Governments	\$2,563,488.82
Industry	\$2,115,934.63
Industry - ACE	\$7,258,189.31
Associations, Societies & Foundations	\$2,408,319.42
Brilliant Catalyst	\$1,462,657.36
Brilliant Energy Institute	\$152,059.00
Research Donations (Advancement)	\$1,014,616.13
Other	\$776,455.41
Total Other Sources	\$15,188,231.26
Total Cash	\$29,703,746.48
Total In-Kind	\$833,408.00
TOTAL	\$30,537,154.48



Percentage of Total Research Grants Held by Faculty, 2025-2026

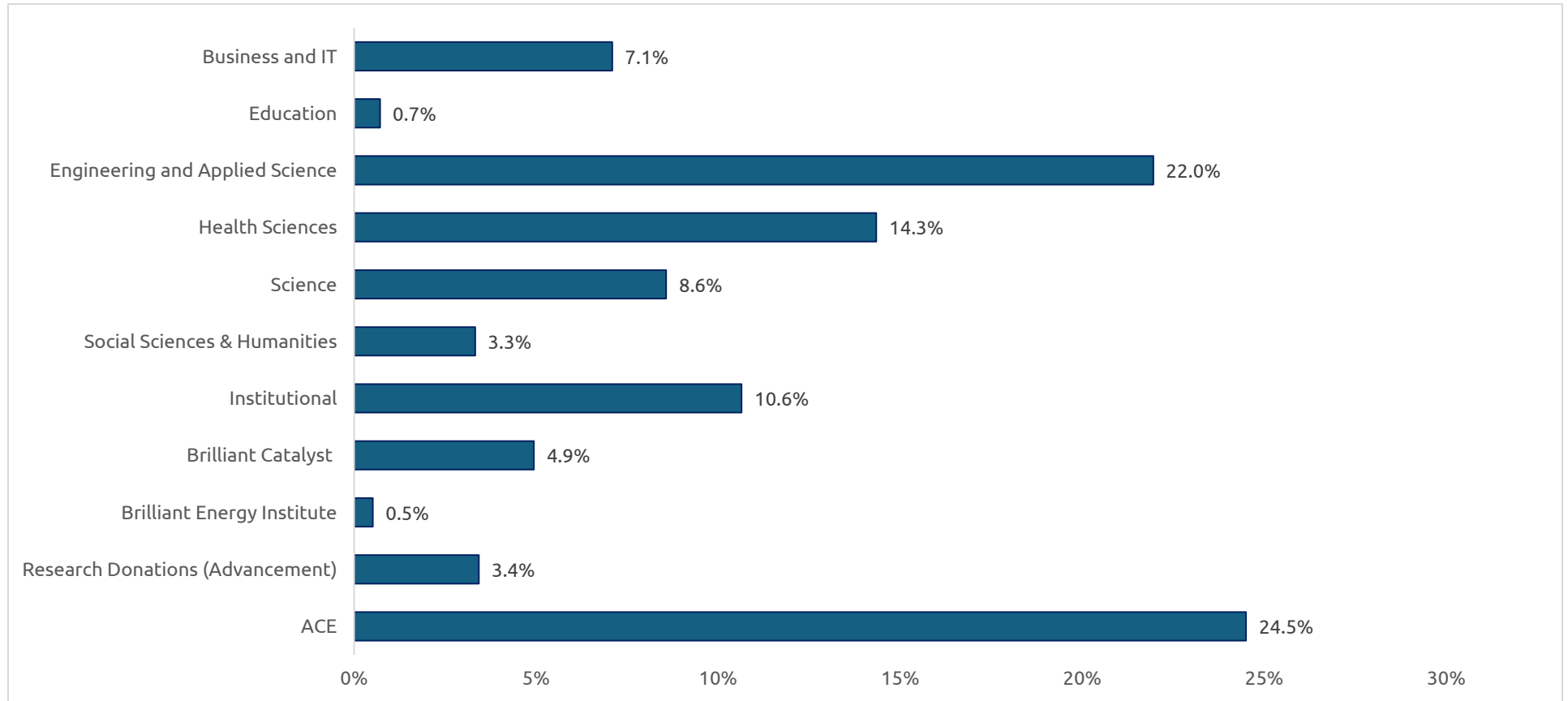

Research Grants and Contracts from Tri-Council by Faculty/School, 2025-2026

Tri-Council	FBIT	FED	FEAS	FHSCI	FSCI	FSSH	Institutional	Staff	Total
CIHR	-	-	-	\$481,960.38	\$256,275	-	\$6,000	-	\$744,235.38
NSERC	\$607,000	-	\$2,763,059	\$251,000	\$958,067	\$52,000	\$162,000	-	\$4,793,126
SSHRC	\$53,313	\$171,557	-	\$121,542	\$68,960	\$217,513	\$66,235	\$26,441	\$725,561
Total	\$660,313	\$171,557	\$2,763,059	\$854,502.38	\$1,283,302	\$269,513	\$234,235	\$26,441	\$6,262,922.38

Research Grants by Faculty

Faculty	2021-2022	2022-2023	2023-2024	2024-2025	2025-2026
Business and Information Technology	\$1,451,138	\$1,183,088	\$1,193,485	\$978,778	\$2,100,090
Education	\$267,803	\$468,021	\$415,163	\$153,540	\$210,557
Energy Systems and Nuclear Science	\$1,781,949	\$1,685,617	-	-	-
Engineering and Applied Science	\$4,516,648	\$4,289,389	\$6,294,562	\$7,112,519	\$6,503,196
Health Sciences	\$3,182,978	\$3,524,086	\$2,828,718	\$3,136,076	\$4,249,174
Science	\$3,661,592	\$2,343,856	\$2,183,828	\$2,087,223	\$2,539,196
Social Science and Humanities	\$1,063,061	\$1,126,360	\$1,718,775	\$1,875,795	\$984,817
Institutional	\$6,609,057	\$3,078,948	\$3,256,734	\$2,934,475	\$3,152,754
Brilliant Catalyst*		\$661,658	\$1,335,205	\$1,783,353	\$1,462,657
Brilliant Energy Institute*			\$590,780	\$113,000	\$152,059
Research Donations (Advancement)			\$1,095,091	\$417,000	\$1,014,616
ACE**	\$2,994,365	\$4,818,679	\$4,396,701	\$3,244,853	\$7,258,189
Total	\$25,528,591	\$23,179,703	\$25,309,042	\$23,836,612	\$29,703,746

* Brilliant Energy Institute (BEI) & Brilliant Catalyst is broken out from awarded funding beginning in 2022

**ACE is broken out from awarded funding beginning in 2020



[Return to Table of Contents](#)



Ontario Tech Fact Book 2025-2026 June 2026 | **Page 47**

Total Research Grants and Contracts

Funding Source	2021-2022	2022-2023	2023-2024	2024-2025	2025-2026
Total Federal Government	\$12,758,600	\$11,360,860	\$12,419,993	\$12,358,042	\$11,952,026
Total Provincial Government	\$1,881,067	\$1,440,429	\$1,204,221	\$947,200	\$2,563,489
Total Other Sources	\$10,888,924	\$10,378,414	\$11,684,828	\$10,531,370	\$15,188,231
Total	\$25,528,591	\$23,179,703	\$25,309,042	\$23,836,612	\$29,703,746

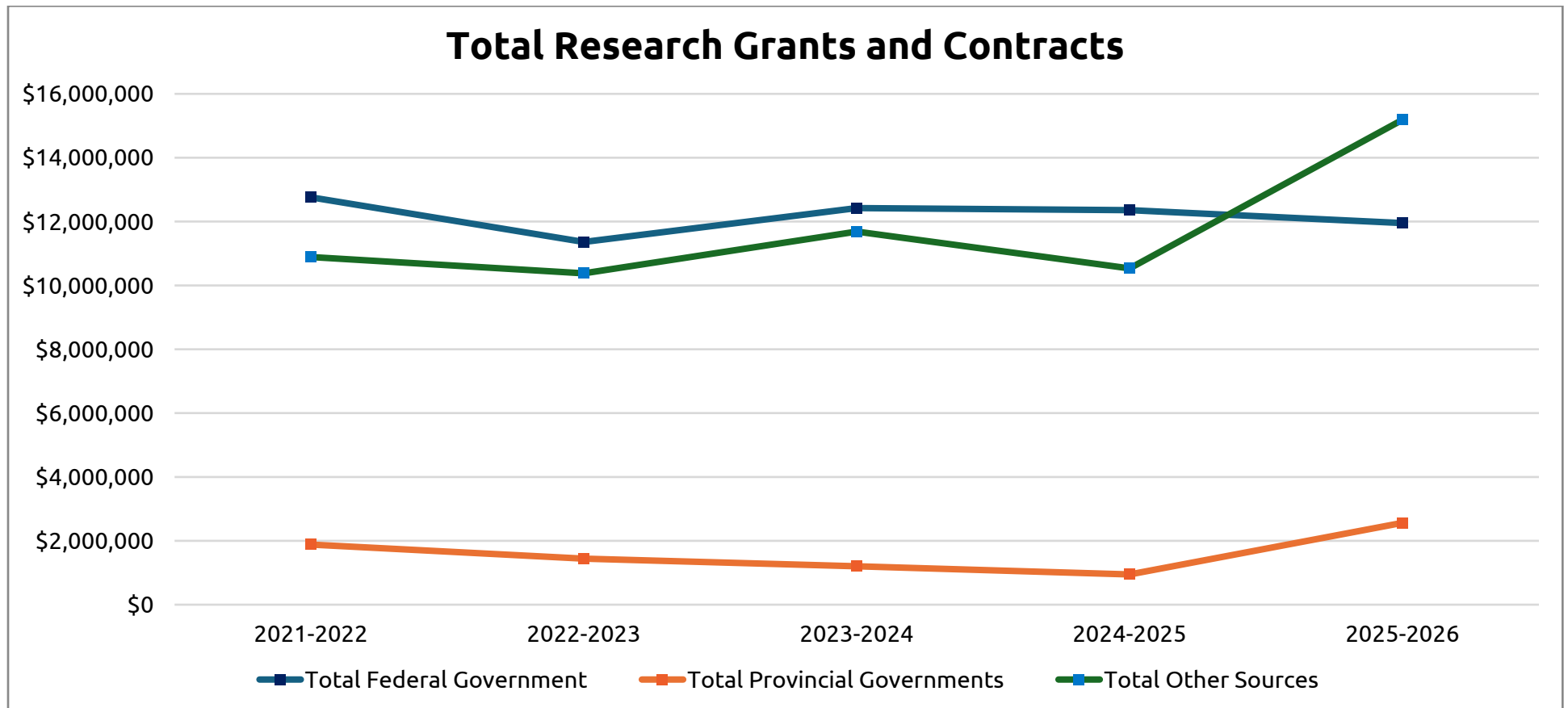

Research Intensity Per Capita

	2021-2022	2022-2023	2023-2024	2024-2025	2025-2026
Research Intensity	\$116,568.91	\$105,362.28	\$113,915	\$108,348	\$134,406

Research intensity: Total number of Core Faculty divided by sponsored funding in academic year (excluding Academic Executives)



Finance

Ontario Tech University's Finance department publishes reference information online, including financial statements and operating budgets. This can be found at: <https://sites.ontariotechu.ca/finance/planning-reporting/index.php>



Library

Number of Library Holdings

Category	2021-2022	2022-2023	2023-2024	2024-2025	2025-2026
Books & Government Publications (# volumes)	61,535	59,020	58,059	58,232	58,199
E-books (# titles)	1,088,061	1,372,411	1,460,676	1,468,573	1,489,095
E-journals (# titles)	164,572	167,892	182,522	180,441	187,420
Print Journals (# titles)	3	2	2	2	1
Sound & Video Recordings (# titles)	29,000	59,738	58,242	74,145	42,851
Total	1,343,171	1,659,063	1,759,501	1,781,393	1,777,566

Notes:

Holdings: Represents Ontario Tech collections.

Ebooks & E-journals: Since 2020-2021, figures have significantly increased due to inclusion of titles available through Open Access (includes government documents) as well as presence of duplicate titles.

Print Journals: There are a total of 22 active and non-active periodical titles. Number recorded reflects active periodical titles (3). Ongoing focus on converting print journals to online access.

Sound & Video Recording: Includes 54,390 eVideos, 4,154 eAudio, 394 other visual e-material, 478 physical sound & video titles, and 322 other non-print titles. New digital resources librarian has enabled more streamlined management of local streaming video collections for discovery and access.

Books & Government Publications: Decrease due to ongoing weeding of print collection, and increased focus on ebook acquisitions.



Library Personnel

Type of Personnel	2021-2022	2022-2023	2023-2024	2024-2025	2025-2026
Professional Librarians & Managers	11.44	12.96	12.52	12.80	13.70
Assistants	16.78	19.97	21.98	22.53	21.90
Students	0	0.68	0.69	0.79	0.69
Total	28.22	33.61	35.19	36.12	36.29

Note: Total numbers for both Ontario Tech University & Durham College funded positions given above. Represents FTE at all libraries

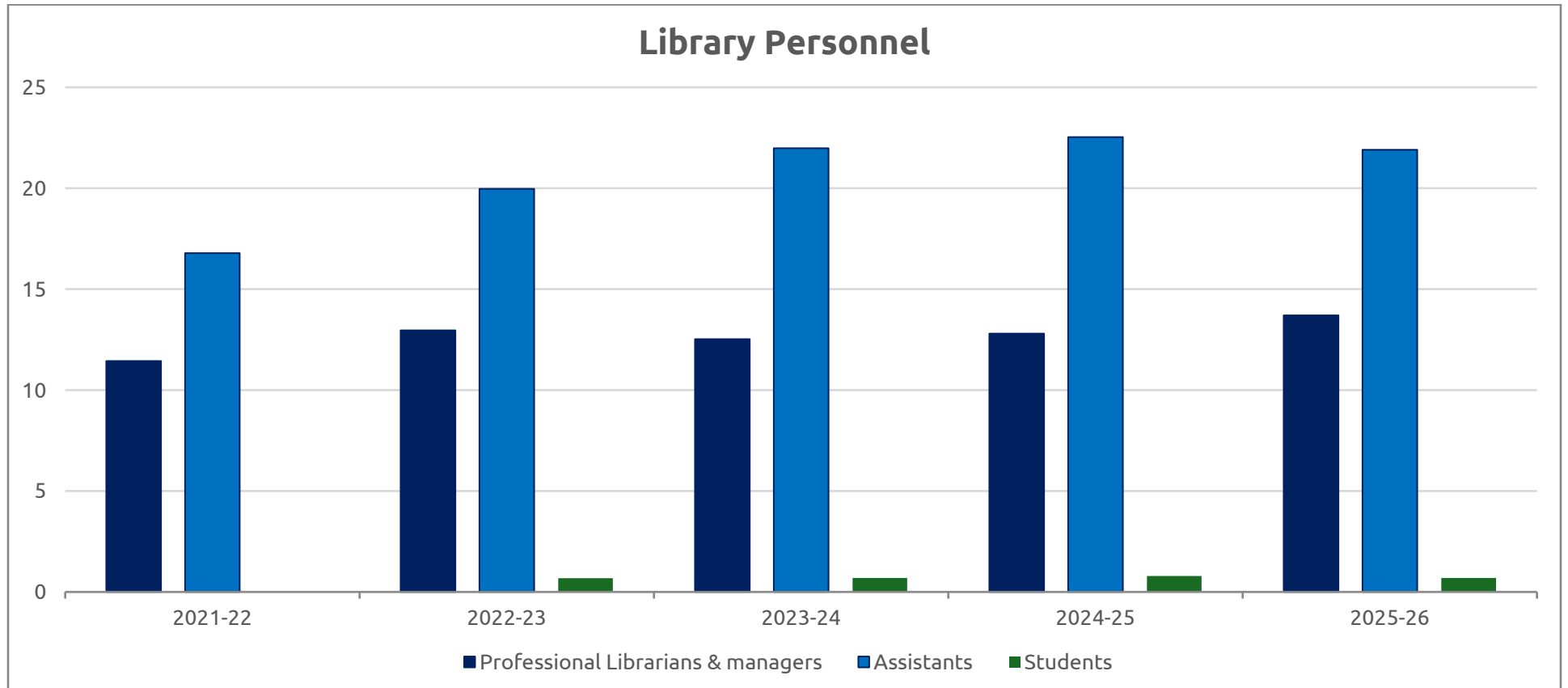

Residences

Residence Accommodation Located on Ontario Tech University/Durham College Property

Residence	Style	Beds Available
Simcoe Village	Quadruple Occupancy – Open Concept	68
Simcoe Village	Double Occupancy – Open Concept	344
Simcoe Village	Semi - Private	214
South Village	Semi - Private	706
West Village	Apartment-style	216
Total		1,548

Notes:

All accommodations are shared with Durham College.
West Residence is available to upper-year students only.



Athletics

*Athletics data is provided by the Athletics department.

Student Athletes by Sport, 2025-2026

	Ontario University Athletics			USPORT			Clubs			Grand Total
	M	F	Total	M	F	Total	M	F	Total	
Hockey	27	26	53	27	26	53	19	9	28	81
Rowing	8	12	20							20
Soccer	29	25	54	29	25	54				54
Basketball	15	17	32	15	17	32				32
Women's Lacrosse	0	25	25							25
Badminton	13	9	22							22
Golf	12	2	14							14
Curling	7	5	12	7	5	12				12
Dance							0	22	22	22
Mixed Volleyball							8	7	15	15
Sitting Volleyball							5	3	8	8
Cricket							12	0	12	12
Ringette							0	10	10	10
Equestrian							0	1	1	1
Total	111	121	232	78	73	151	44	52	96	328



[Return to Table of Contents](#)

Fact Book Glossary

Assistant Professor – A professional rank where a faculty member has completed the doctoral degree and can demonstrate experience or strong potential in the facilitation of learning, scholarly research and/or creative professional practice.

Associate Professor – A professional rank where a faculty member has demonstrated a record as a good and technologically innovative teacher committed to academic excellence and high-quality peer-assessed scholarship and/or creative professional practice.

BIU – Basic Income Unit. BIU = Full-time Equivalent (FTE) multiplied by weighting factor, depending on program of registration and the level of study. This measure of enrolment is used in government funding calculations.

CFI – Canada Foundation for Innovation

CIHR – Canadian Institutes of Health Research

Tenure/Tenure-track Faculty – Any person employed by the university with responsibility for a full range of academic duties (teaching, research and service), who is eligible for tenure or is tenured.

COU – Council of Ontario Universities

CRC – Canada Research Chair

Eligible/ineligible students –Refers to the eligibility of a student for operating grants from the provincial government. A student is considered eligible if he or she is either a Canadian citizen, a permanent resident, an eligible international student or a protected person; and is enrolled at an eligible institution, in a publicly-supported program approved after meeting the specific eligibility criteria set by the Ministry of Training Colleges and Universities.

FTE/FFTE – Full-time Equivalent/Fiscal Full-time Equivalent. Undergraduate and graduate FTEs are counted differently. Undergraduate FTEs are counted as a proportion of a normal full-time load for a particular program and level of registration over an academic year (all terms), or FFTE. Full-time undergraduates normally register for two terms per academic year, and those taking a full course load generate 0.5 FTE each term or 1.0 FFTE in total. Undergraduate students taking fewer courses than a full course load will generate proportionately fewer FTEs, and those taking more than a full course load or earning credits in a third term generate more FTEs. Graduate students are counted per term. By convention, graduate FTEs are approximated by summing FTEs in fall and summer terms. Graduates normally register for three terms. Full-time graduate students generate 1.0 FTE and part-time graduate students 0.3 FTE.

Full-time and part-time status – Students are considered full-time when they take 60 per cent or more of a full course load. Part-time status is designated for students taking less than 60 per cent of a full course load.

Headcount – Every student enrolled is counted as one headcount, regardless of registration status or course load or level of study. Fall term full-time headcounts (counted on November 1) are a commonly used measure for enrolments.

Fact Book Glossary (continued)

MRI – Ministry of Research and Innovation (Ontario)

MCU – Ministry of Colleges and Universities (Ontario)

NCE – Networks of Centres of Excellence (Canada)

NSERC – Natural Sciences and Engineering Research Council of Canada

OCE – Ontario Centres of Excellence

Professor – A professional rank where a faculty member has demonstrated a clear commitment to, and a record of success in, the facilitation of learning and has shown substantial achievement in research and/or creative professional practice as evidenced by the production of a body of scholarly work or creative professional practice that is widely known and respected.

SSHRC – Social Sciences and Humanities Research Council of Canada

Teaching Faculty – Any person employed by the university with a focus on teaching. Classifications under this category include Lecturer and Lecturer and Laboratory Co-ordinator.

Undergraduates and graduates – Undergraduates are enrolled in undergraduate-level programs such as undergraduate diplomas and certificates, and bachelor's degrees; graduates are enrolled in graduate programs such as graduate diplomas and certificates, master's and doctoral degrees.

Contact

Any questions regarding the material contained in this publication should be directed to:

Office of Institutional Research and Analysis (OIRA)

Ontario Tech University (University of Ontario Institute of Technology)
2000 Simcoe Street North
Oshawa, Ontario L1G 0C5
ontariotechu.ca/oira



Acknowledgements

The Office of Institutional Research and Analysis would like to thank individuals from the following departments for their collaboration in the production of this version of the Ontario Tech University Fact Book:

- Durham College / Ontario Tech University residence
- Athletics Department
- Office of Campus Infrastructure and Sustainability
- Office of the Provost
- Communications and Marketing
- Student Awards and Financial Aid office
- Office of the Vice-President, Research and Innovation
- Campus Library

