



AIG Travel Protect App Download and Setup Guide

Helping to keep every journey safe and supported. Looking ahead for you.

AIG Travel Protect App is your ultimate companion for helping you stay safe during your travels.

By downloading the app, you gain access to a powerful tool that provides peace of mind, empowers you with real-time safety information, and helps ensure your well-being is never compromised.



How To Download & Login



1 Download app

2 Click create new account / sign up

3 Enter your email and choose your desired password

4 Enter your policy number*
Please note: Case-sensitive - enter the # exactly as provided

5 Register and verify your phone number

How To Change privacy & update location settings

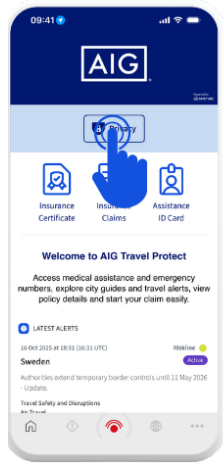

1 From home screen, push Privacy at the top

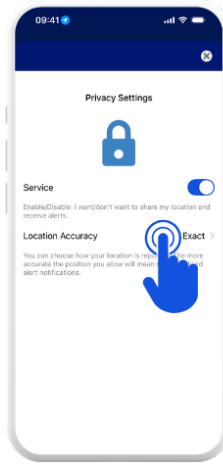

2 Push Location Accuracy

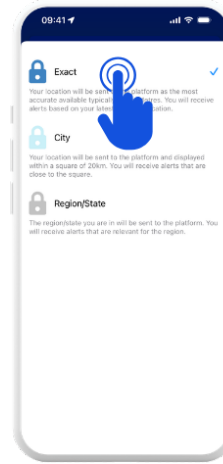

3 Select your desired level

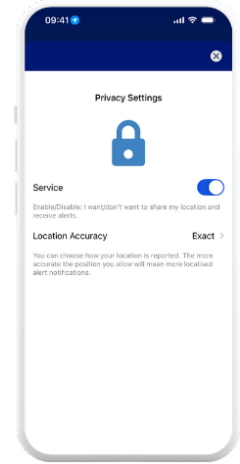

4 Keep service ON

How To Initiate Emergency Assistance

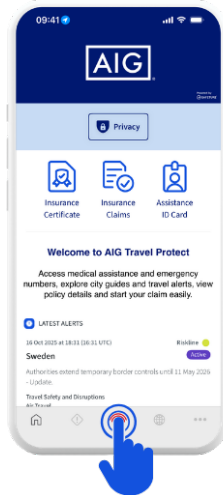

1 From home screen, push the Assistance button

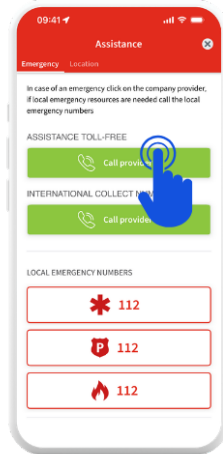

2 Push one of the assistance buttons

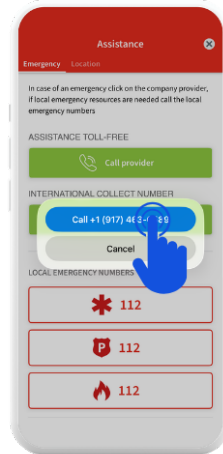

3 Push the phone number to initiate a call to assistance

Useful Information

Change Privacy Settings

To change your privacy, go to “Privacy” on the Welcome page in the app. You can set privacy for exact, city, and region/state. Also, make sure to set your phone’s location to “always allow.”

Filter Alerts

You can filter what you see on the map in the app’s alerts tab. You’ll always get relevant push notifications based on your location, regardless of risk.

Battery Usage

The app generally uses about 2% of your battery when in the background during a day.

No Internet Connection

The app works on both wifi and cellular networks. For the fastest experience we recommend using the app on wifi. Critical functions like the emergency assistance button will always be available.

App Languages

The app supports system languages and offers machine translation for more languages. You can change this in the app’s settings.